

## G ELECTRICAL WIRING ROUTING

### Position of Parts in Engine Compartment

[LHD]

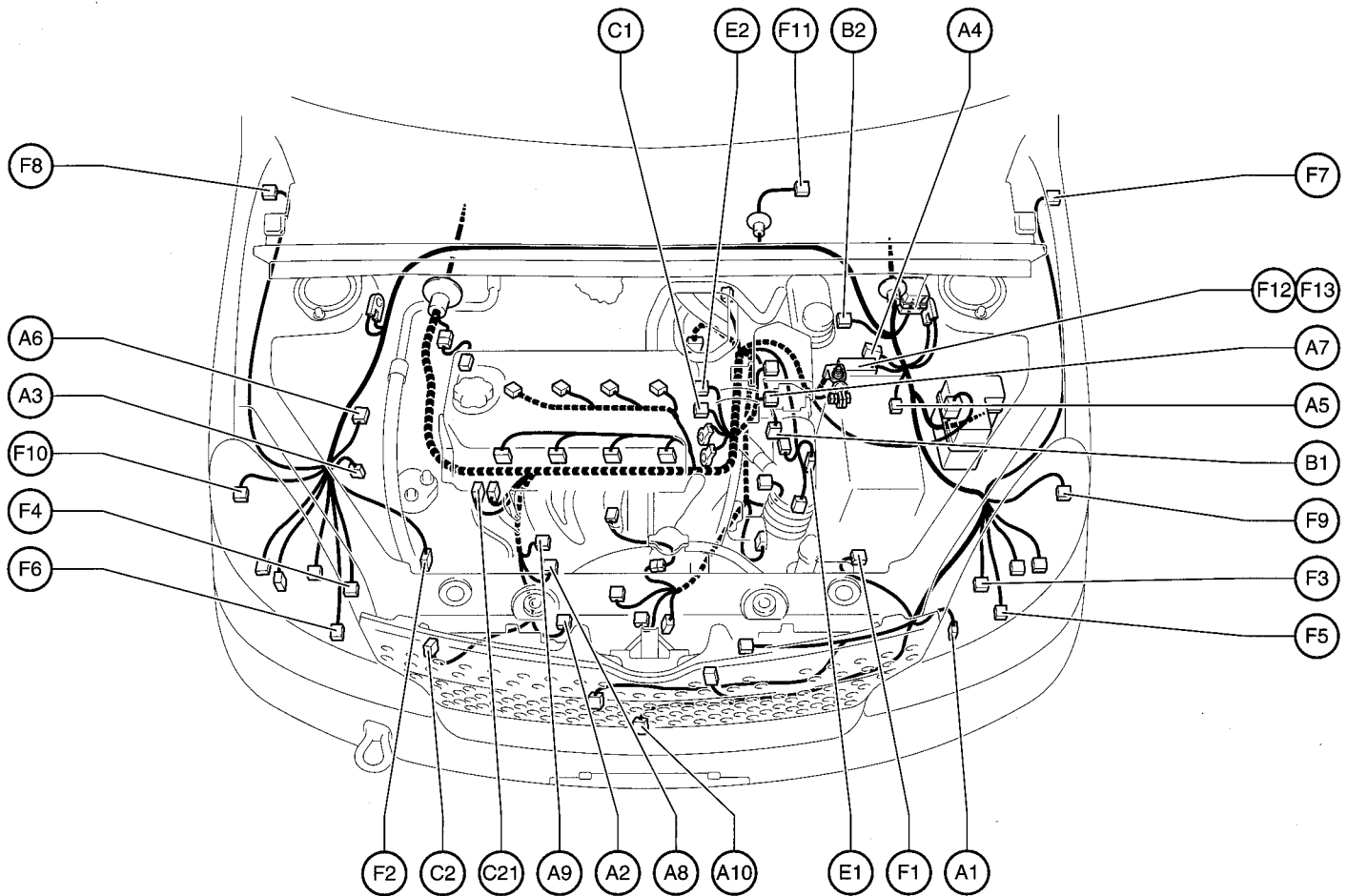

- A 1 A/C Condenser Fan Resistor
- A 2 A/C Magnetic Clutch
- A 3 A/C Triple Pressure SW  
(A/C Dual and Single Pressure SW)
- A 4 ABS Actuator with ECU
- A 5 ABS Speed Sensor Front LH
- A 6 ABS Speed Sensor Front RH
- A 7 Air Flow Meter
- A 8 Alternator
- A 9 Alternator
- A10 Ambient Temp. Sensor
- B 1 Back-Up Light SW (M/T)
- B 2 Brake Fluid Level Warning SW
- C 1 Camshaft Position Sensor
- C 2 Crankshaft Position Sensor
- C21 Camshaft Timing Oil Control Valve

- E 1 ECT Solenoid
- E 2 EFI Water Temp. Sensor
- F 1 Front Airbag Sensor LH
- F 2 Front Airbag Sensor RH
- F 3 Front Clearance Light LH
- F 4 Front Clearance Light RH
- F 5 Front Fog Light LH
- F 6 Front Fog Light RH
- F 7 Front Side Turn Signal Light LH
- F 8 Front Side Turn Signal Light RH
- F 9 Front Turn Signal Light LH
- F 10 Front Turn Signal Light RH
- F 11 Front Wiper Motor
- F 12 Fusible Link Block
- F 13 Fusible Link Block

## Position of Parts in Engine Compartment

**[LHD]**

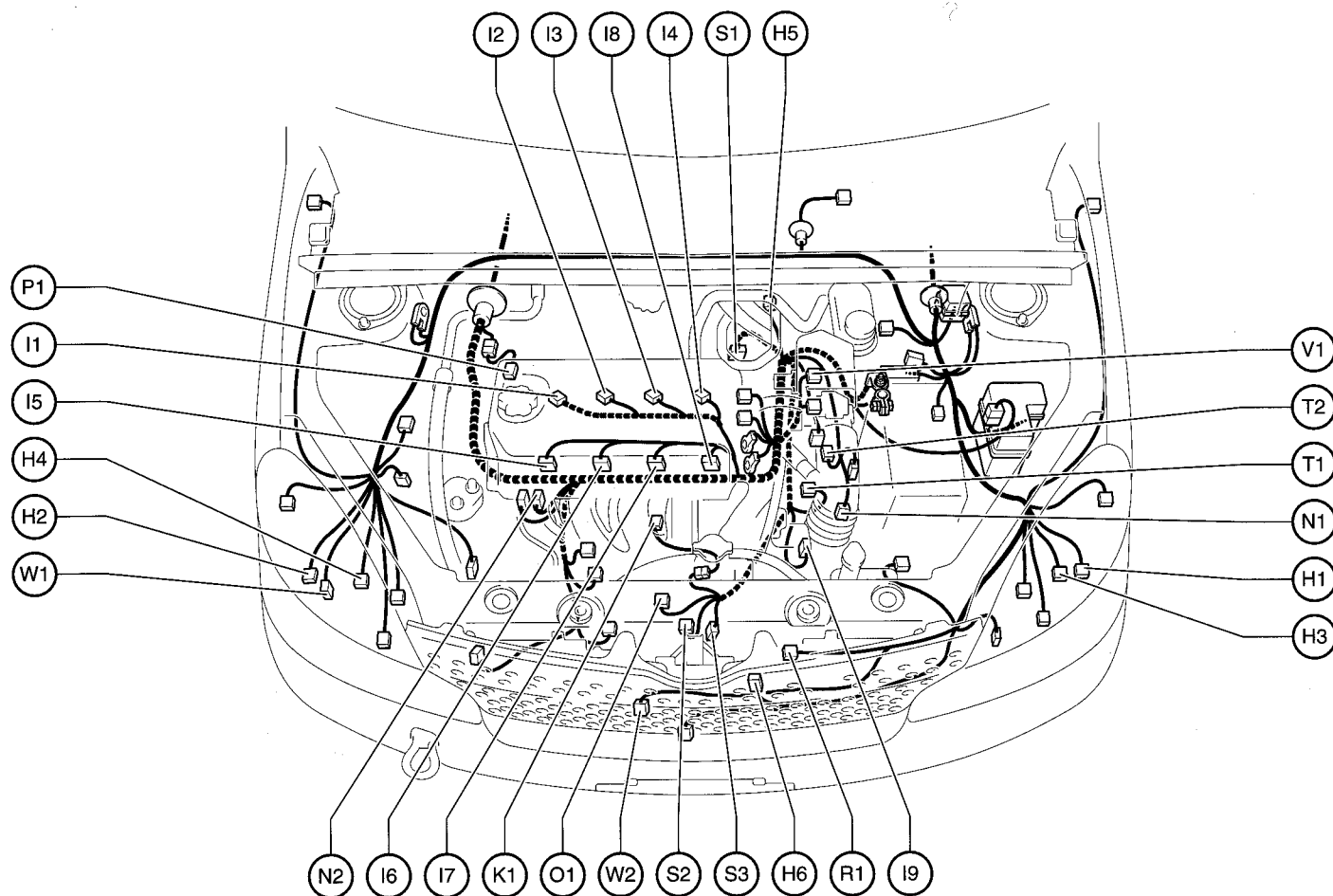

H 1 Headlight Beam Level Control Actuator LH  
 H 2 Headlight Beam Level Control Actuator RH  
 H 3 Headlight LH  
 H 4 Headlight RH  
 H 5 Heated Oxygen Sensor (Bank 1 Sensor 1)  
 H 6 Horn

I 1 Ignition Coil and Igniter No.1  
 I 2 Ignition Coil and Igniter No.2  
 I 3 Ignition Coil and Igniter No.3  
 I 4 Ignition Coil and Igniter No.4  
 I 5 Injector No.1  
 I 6 Injector No.2  
 I 7 Injector No.3  
 I 8 Injector No.4  
 I 9 ISC Valve

K 1 Knock Sensor

N 1 Neutral Start SW (A/T)  
 N 2 Noise Filter (Ignition)

O 1 Oil Pressure SW

P 1 Power Steering Oil Pressure Sensor

R 1 Radiator Fan Motor

S 1 Speed Sensor (Combination Meter)

S 2 Starter

S 3 Starter

T 1 Throttle Position Sensor

T 2 Turbine Speed Sensor

V 1 VSV (EVAP)

W 1 Washer Motor

W 2 Water Temp. SW

## G ELECTRICAL WIRING ROUTING

### Position of Parts in Instrument Panel

[LHD]

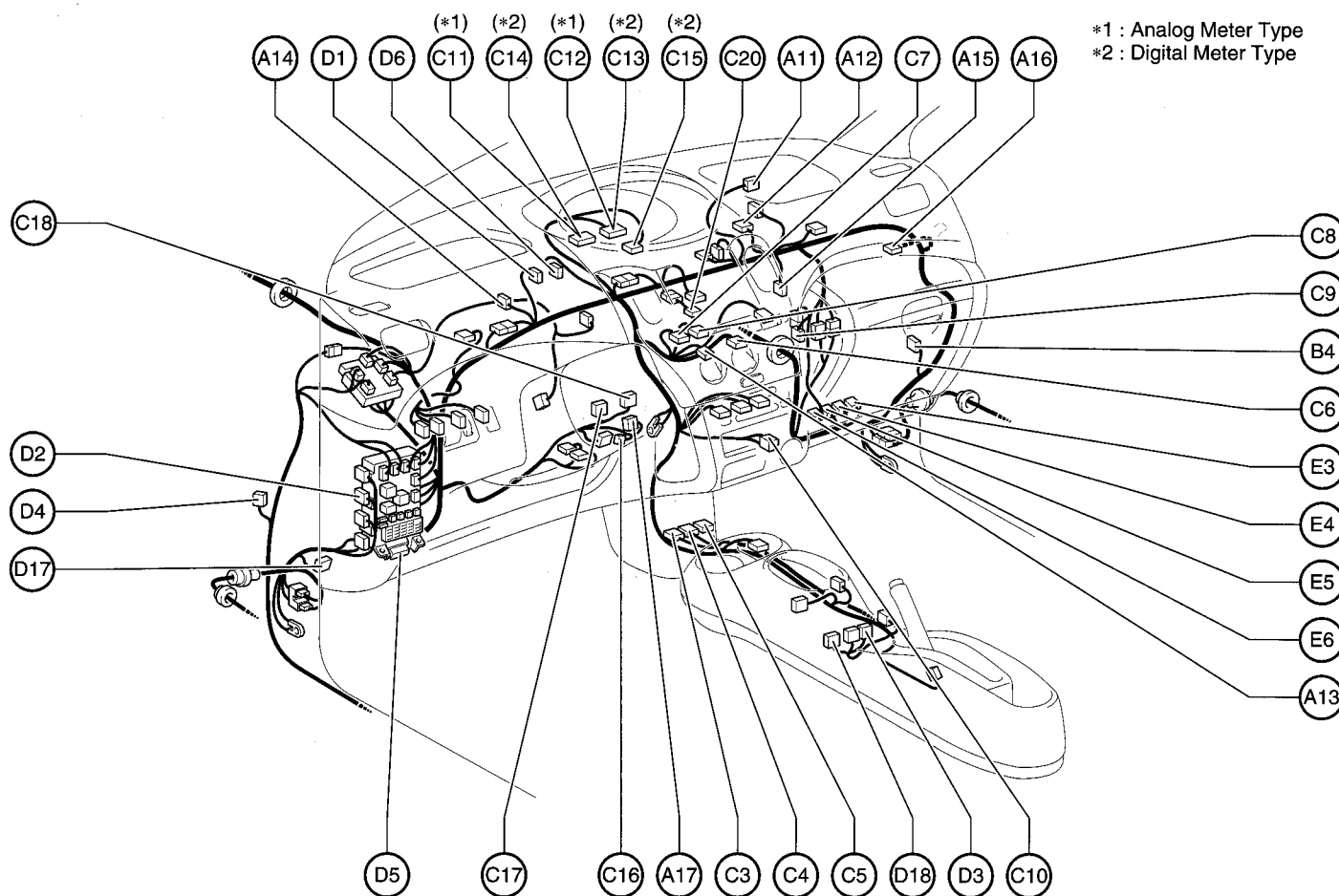

\*1 : Analog Meter Type  
\*2 : Digital Meter Type

A 11 A/C Amplifier  
A 12 A/C Thermistor  
A 13 A/C Volume SW  
A 14 Active Light Relay  
A 15 Air Inlet Control Servo Motor  
A 16 Airbag Squib (Front Passenger's Airbag Assembly)  
A 17 Airbag Squib (Steering Wheel Pad)

B 4 Blower Motor and Resistor

C 3 Center Airbag Sensor Assembly  
C 4 Center Airbag Sensor Assembly  
C 5 Center Airbag Sensor Assembly  
C 6 Center Cluster SW  
C 7 Center Cluster SW  
C 8 Center Cluster SW  
C 9 Check Connector (Power Steering)  
C 10 Cigarette Lighter  
C 11 Combination Meter  
C 12 Combination Meter  
C 13 Combination Meter

C 14 Combination Meter  
C 15 Combination Meter  
C 16 Combination SW  
C 17 Combination SW  
C 18 Combination SW  
C 20 Clock

D 1 Daytime Running Light Relay  
D 2 Defogger Relay  
D 3 Diode (Front Fog Light)  
D 4 Diode (Moon Roof)  
D 5 DLC3  
D 6 Door Lock Control Relay  
D 17 Diode (Door Courtesy SW)  
D 18 Door Lock Control SW

E 3 Engine and ECT ECU (A/T) or Engine ECU (M/T)  
E 4 Engine and ECT ECU (A/T) or Engine ECU (M/T)  
E 5 Engine and ECT ECU (A/T)  
E 6 Engine and ECT ECU (A/T) or Engine ECU (M/T)

## Position of Parts in Instrument Panel

**[LHD]**

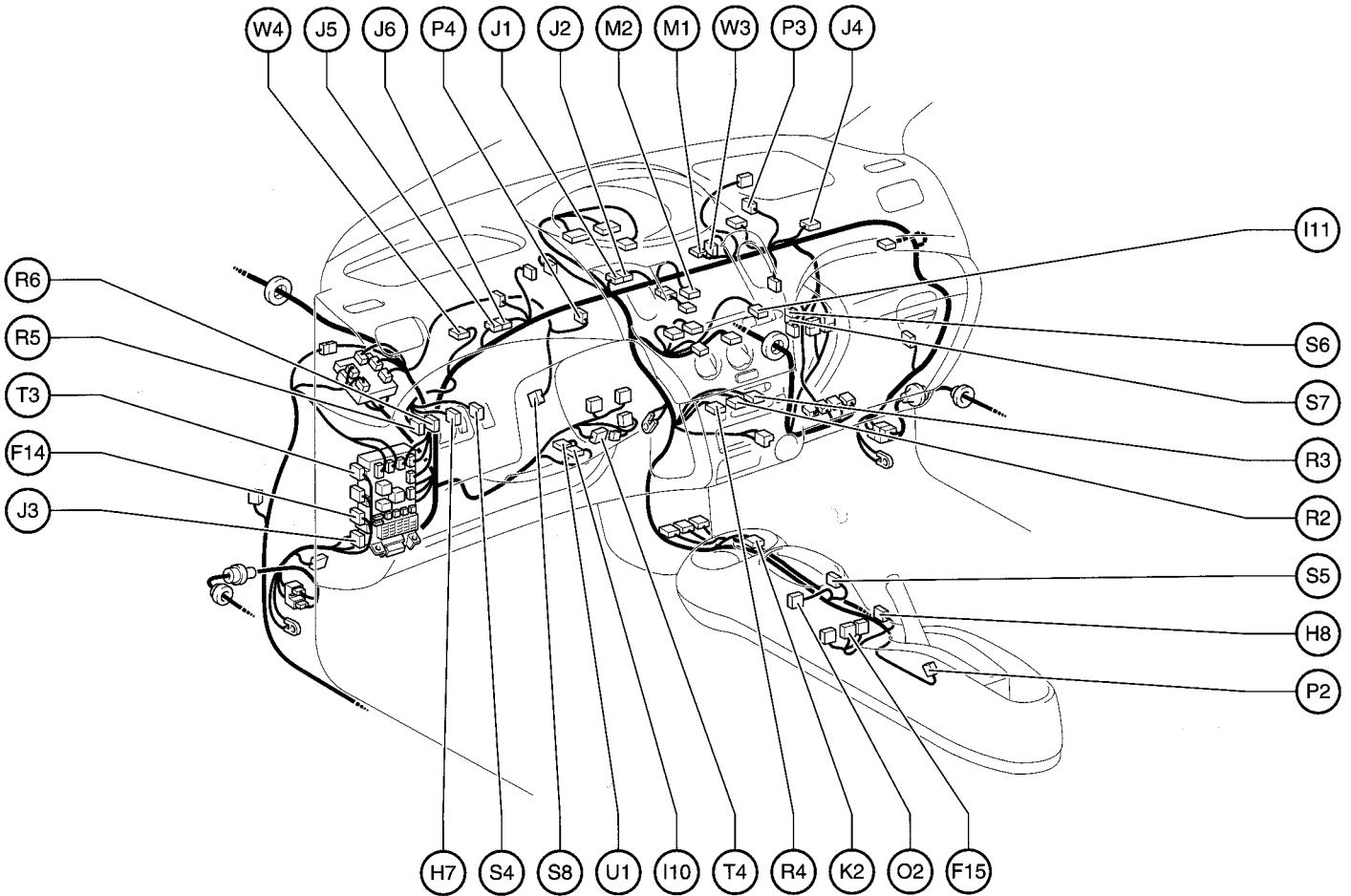

F 14 Front Fog Light Relay

F 15 Front Fog Light SW

H 7 Headlight Beam Level Control SW

H 8 Heated Oxygen Sensor (Bank 1 Sensor 2)

I 10 Ignition SW

I 11 Inside SW

J 1 Junction Connector

J 2 Junction Connector

J 3 Junction Connector

J 4 Junction Connector

J 5 Junction Connector

J 6 Junction Connector

K 2 Kick Down SW

M 1 Max Hot and Foot Mode SW

M 2 Multi Display

O 2 O/D Main SW

P 2 Parking Brake SW

P 3 PTC Amplifier

P 4 PTC Heater

R 2 Radio and Player

R 3 Radio and Player

R 4 Radio and Player

R 5 Rear Fog Light SW

R 6 Remote Control Mirror SW

S 4 Seat Heater SW

S 5 Shift Lock Control SW

S 6 Short Connector

S 7 Short Connector

S 8 Stop Light SW

T 3 Taillight Relay

T 4 Transponder Key Amplifier

U 1 Unlock Warning SW

W 3 Water Temp. Sensor

W 4 Wireless Door Lock Control Receiver

## G ELECTRICAL WIRING ROUTING

### Position of Parts in Body

[LHD]

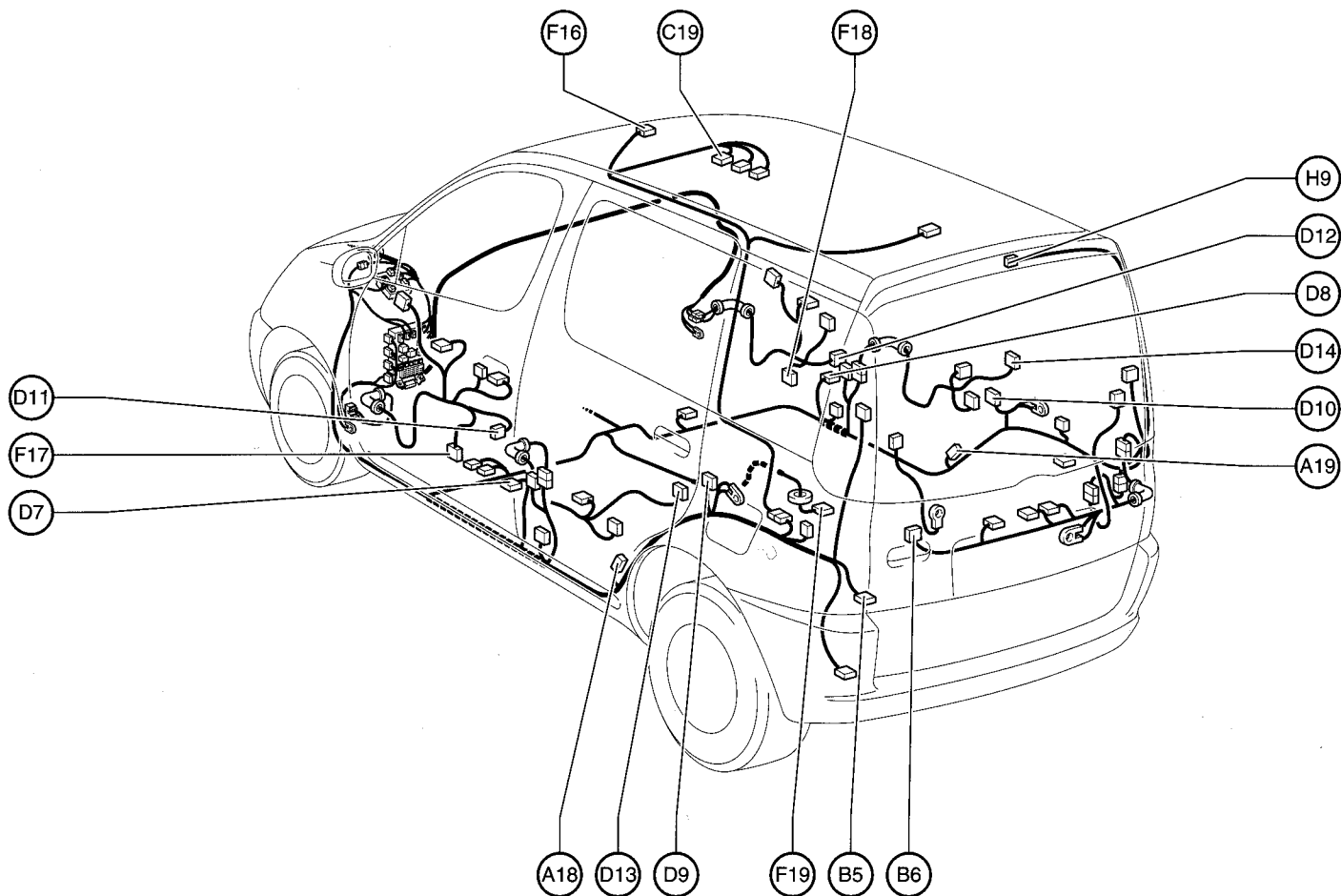

A18 ABS Speed Sensor Rear LH  
A19 ABS Speed Sensor Rear RH

B 5 Back Door Courtesy SW  
B 6 Back Door Lock Motor

C19 Center Interior Light

D 7 Door Courtesy SW (Driver's Side)  
D 8 Door Courtesy SW (Front Passenger's Side)  
D 9 Door Courtesy SW Rear LH  
D10 Door Courtesy SW Rear RH  
D11 Door Lock Motor and SW (Driver's Side)  
D12 Door Lock Motor and SW (Front Passenger's Side)  
D13 Door Lock Motor Rear LH  
D14 Door Lock Motor Rear RH

F16 Front Interior Light  
F17 Front Speaker LH (Door)  
F18 Front Speaker RH (Door)  
F19 Fuel Pump and Fuel Sender

H 9 High Mounted Stop Light

## Position of Parts in Body

[LHD]

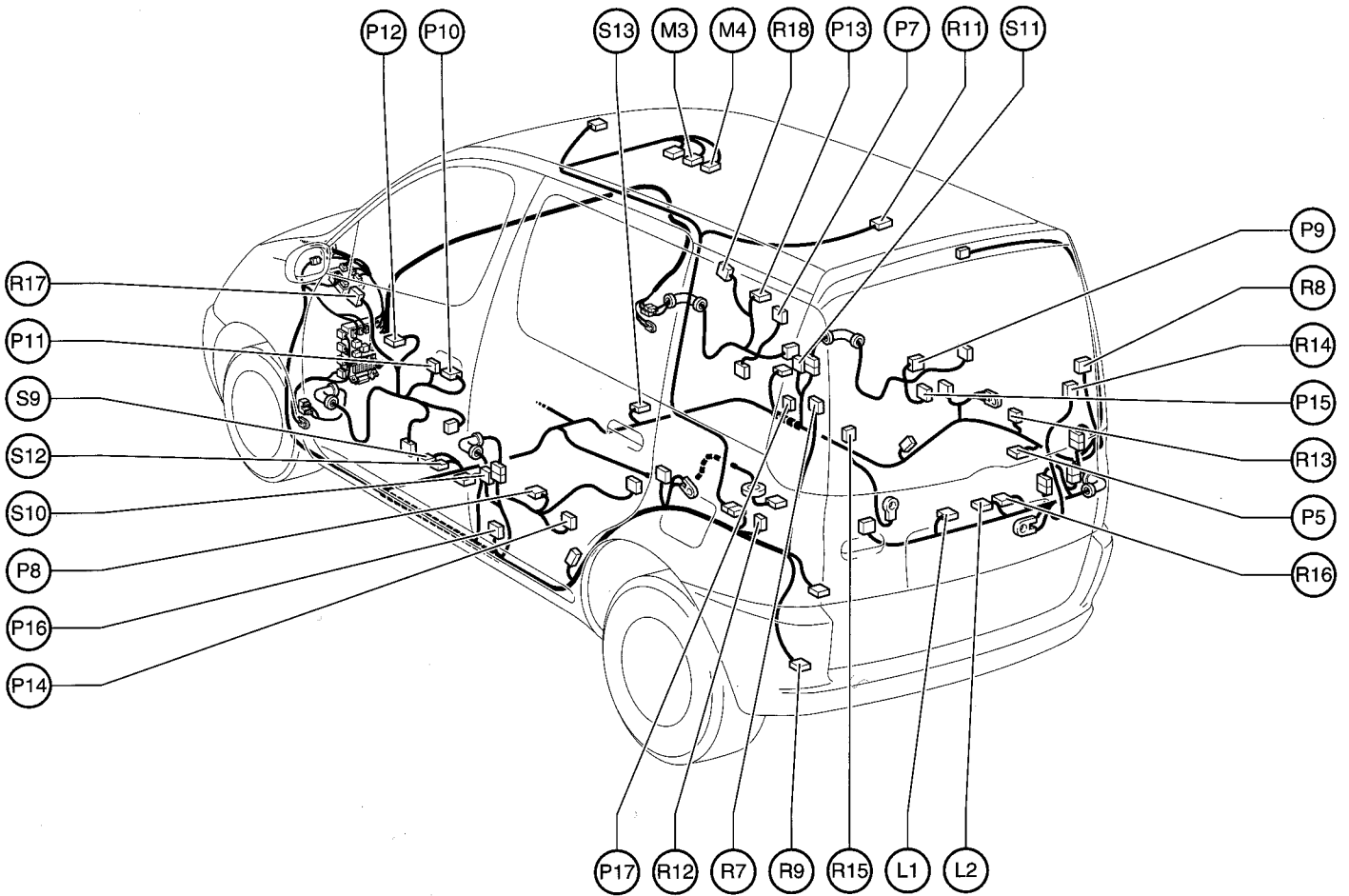

L 1 License Plate Light LH  
L 2 License Plate Light RH

M 3 Moon Roof Control SW and Moon Roof Control Relay  
M 4 Moon Roof Motor and Limit SW

P 5 Power Outlet  
P 7 Power Window Control SW Front RH  
P 8 Power Window Control SW Rear LH  
P 9 Power Window Control SW Rear RH  
P10 Power Window Master SW  
P11 Power Window Master SW  
P12 Power Window Motor Front LH  
P13 Power Window Motor Front RH  
P14 Power Window Motor Rear LH  
P15 Power Window Motor Rear RH  
P16 Pretensioner LH  
P17 Pretensioner RH

R 7 Rear Combination Light LH  
R 8 Rear Combination Light RH  
R 9 Rear Fog Light LH  
R11 Rear Interior Light  
R12 Rear Speaker LH  
R13 Rear Speaker RH  
R14 Rear Window Defogger  
R15 Rear Window Defogger  
R16 Rear Wiper Motor  
R17 Remote Control Mirror LH  
R18 Remote Control Mirror RH

S 9 Seat Heater  
S10 Side Airbag Sensor LH  
S11 Side Airbag Sensor RH  
S12 Side Airbag Squib LH  
S13 Side Airbag Squib RH

## G ELECTRICAL WIRING ROUTING

### Position of Parts in Engine Compartment

[RHD]

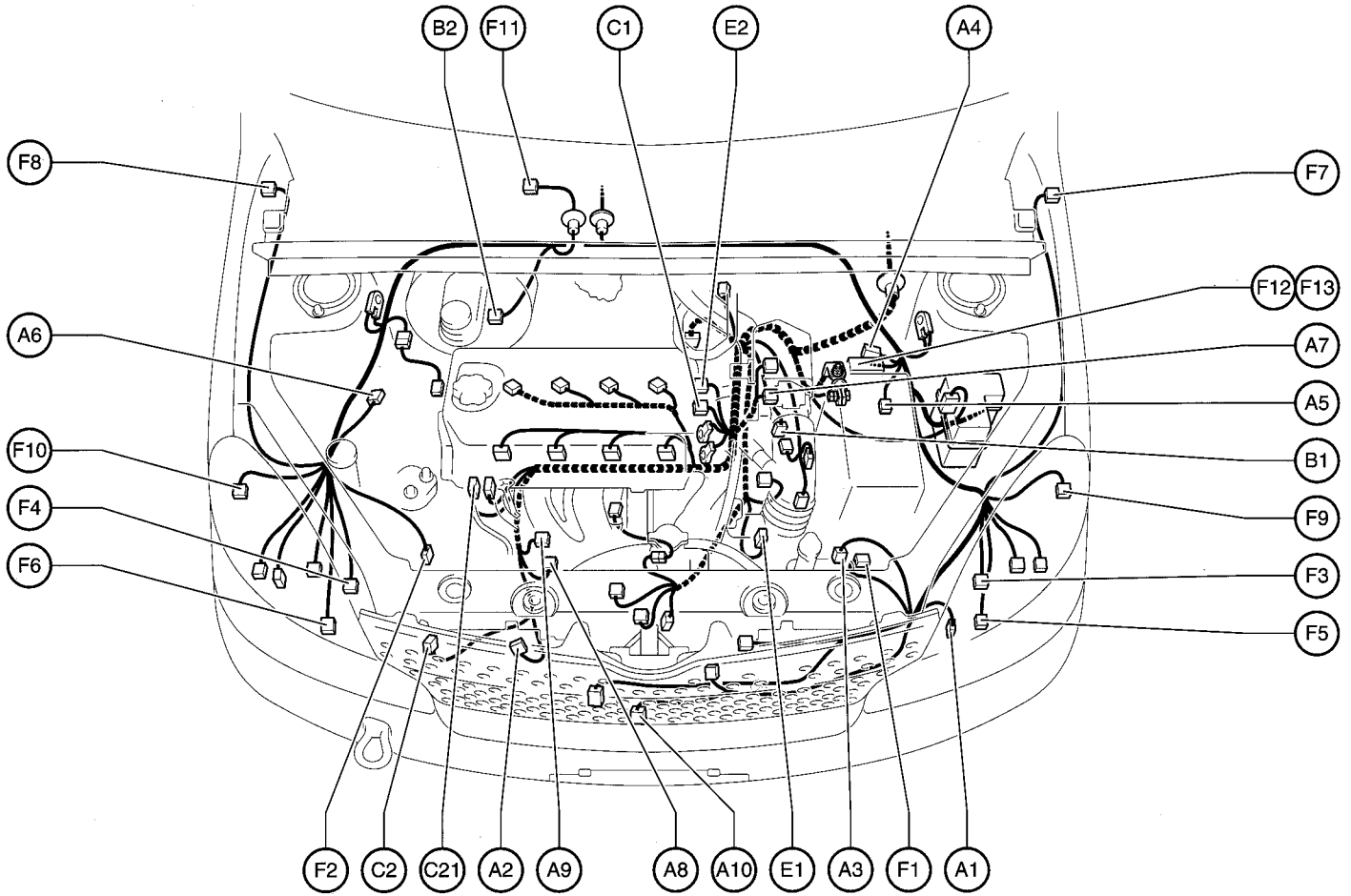

- A 1 A/C Condenser Fan Resistor
- A 2 A/C Magnetic Clutch
- A 3 A/C Triple Pressure SW  
(A/C Dual and Single Pressure SW)
- A 4 ABS Actuator with ECU
- A 5 ABS Speed Sensor Front LH
- A 6 ABS Speed Sensor Front RH
- A 7 Air Flow Meter
- A 8 Alternator
- A 9 Alternator
- A10 Ambient Temp. Sensor
- B 1 Back-Up Light SW (M/T)
- B 2 Brake Fluid Level Warning SW
- C 1 Camshaft Position Sensor
- C 2 Crankshaft Position Sensor
- C21 Camshaft Timing Oil Control Valve

- E 1 ECT Solenoid
- E 2 EFI Water Temp. Sensor
- F 1 Front Airbag Sensor LH
- F 2 Front Airbag Sensor RH
- F 3 Front Clearance Light LH
- F 4 Front Clearance Light RH
- F 5 Front Fog Light LH
- F 6 Front Fog Light RH
- F 7 Front Side Turn Signal Light LH
- F 8 Front Side Turn Signal Light RH
- F 9 Front Turn Signal Light LH
- F10 Front Turn Signal Light RH
- F11 Front Wiper Motor
- F12 Fusible Link Block
- F13 Fusible Link Block

## Position of Parts in Engine Compartment

**[RHD]**

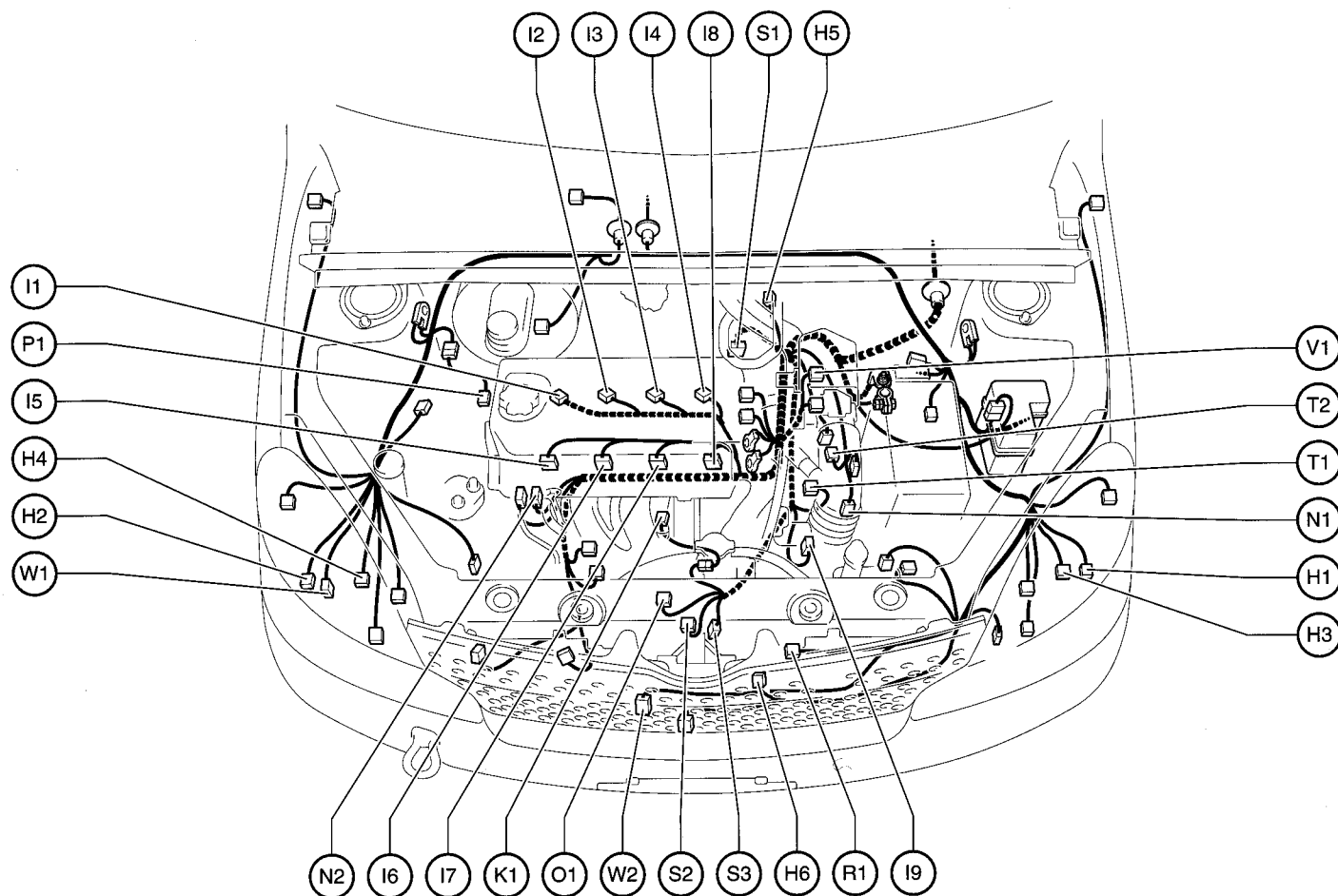

H 1 Headlight Beam Level Control Actuator LH  
 H 2 Headlight Beam Level Control Actuator RH  
 H 3 Headlight LH  
 H 4 Headlight RH  
 H 5 Heated Oxygen Sensor (Bank 1 Sensor 1)  
 H 6 Horn

I 1 Ignition Coil and Igniter No.1  
 I 2 Ignition Coil and Igniter No.2  
 I 3 Ignition Coil and Igniter No.3  
 I 4 Ignition Coil and Igniter No.4  
 I 5 Injector No.1  
 I 6 Injector No.2  
 I 7 Injector No.3  
 I 8 Injector No.4  
 I 9 ISC Valve

K 1 Knock Sensor

N 1 Neutral Start SW (A/T)  
 N 2 Noise Filter (Ignition)

O 1 Oil Pressure SW

P 1 Power Steering Oil Pressure Sensor

R 1 Radiator Fan Motor

S 1 Speed Sensor (Combination Meter)

S 2 Starter

S 3 Starter

T 1 Throttle Position Sensor

T 2 Turbine Speed Sensor

V 1 VSV (EVAP)

W 1 Washer Motor

W 2 Water Temp. SW



## G ELECTRICAL WIRING ROUTING

### Position of Parts in Instrument Panel

[RHD]

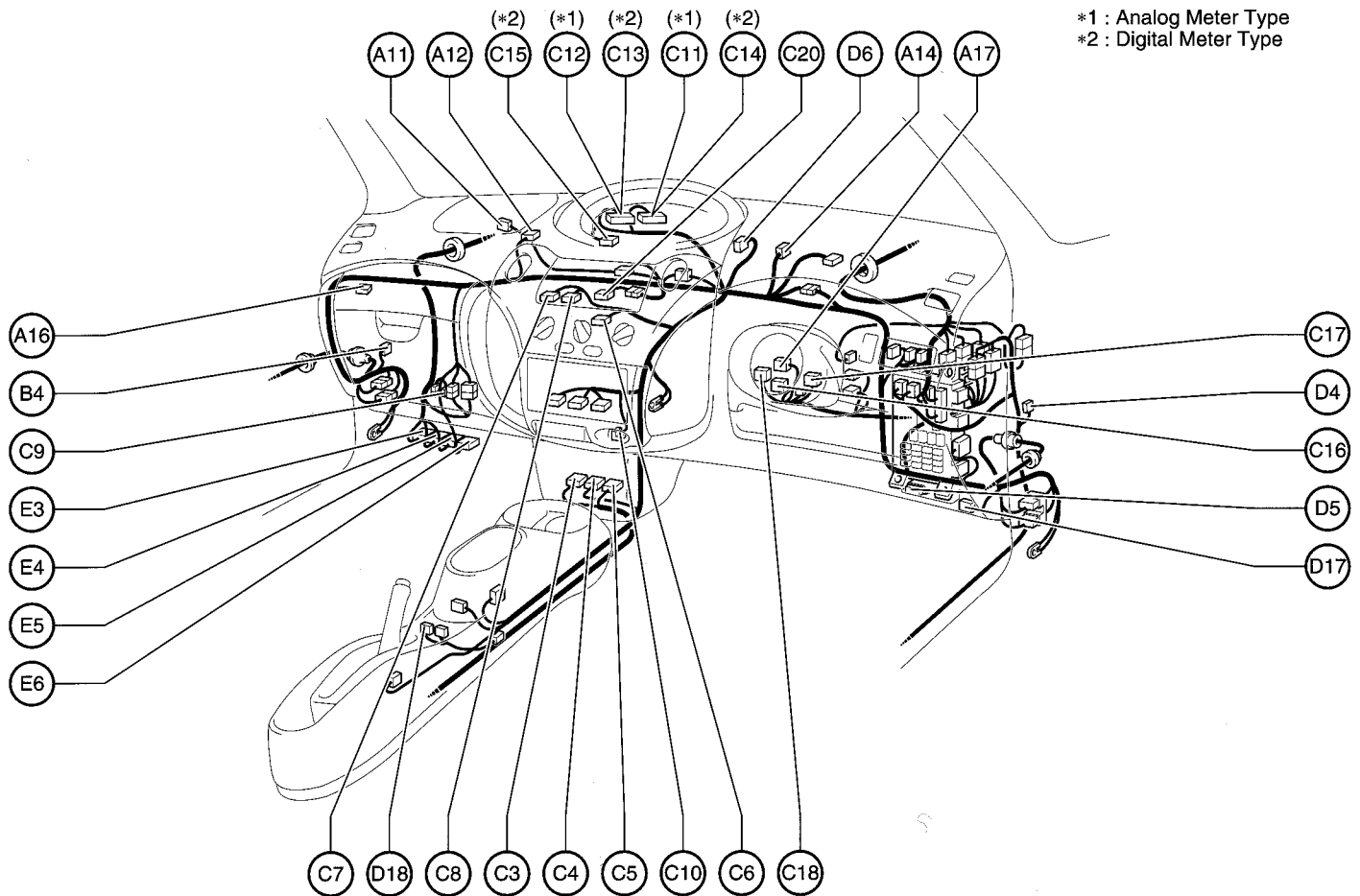

\*1 : Analog Meter Type  
\*2 : Digital Meter Type

A 11 A/C Amplifier  
A 12 A/C Thermistor  
A 14 Active Light Relay  
A 16 Airbag Squib (Front Passenger's Airbag Assembly)  
A 17 Airbag Squib (Steering Wheel Pad)

B 4 Blower Motor and Resistor

C 3 Center Airbag Sensor Assembly  
C 4 Center Airbag Sensor Assembly  
C 5 Center Airbag Sensor Assembly  
C 6 Center Cluster SW  
C 7 Center Cluster SW  
C 8 Center Cluster SW  
C 9 Check Connector (Power Steering)  
C 10 Cigarette Lighter  
C 11 Combination Meter  
C 12 Combination Meter

C 13 Combination Meter  
C 14 Combination Meter  
C 15 Combination Meter  
C 16 Combination SW  
C 17 Combination SW  
C 18 Combination SW  
C 20 Clock

D 4 Diode (Moon Roof)  
D 5 DLC3  
D 6 Door Lock Control Relay  
D 17 Diode (Door Courtesy SW)  
D 18 Door Lock Control SW

E 3 Engine and ECT ECU (A/T) or Engine ECU (M/T)  
E 4 Engine and ECT ECU (A/T) or Engine ECU (M/T)  
E 5 Engine and ECT ECU (A/T)  
E 6 Engine and ECT ECU (A/T) or Engine ECU (M/T)

## Position of Parts in Instrument Panel

**[RHD]**

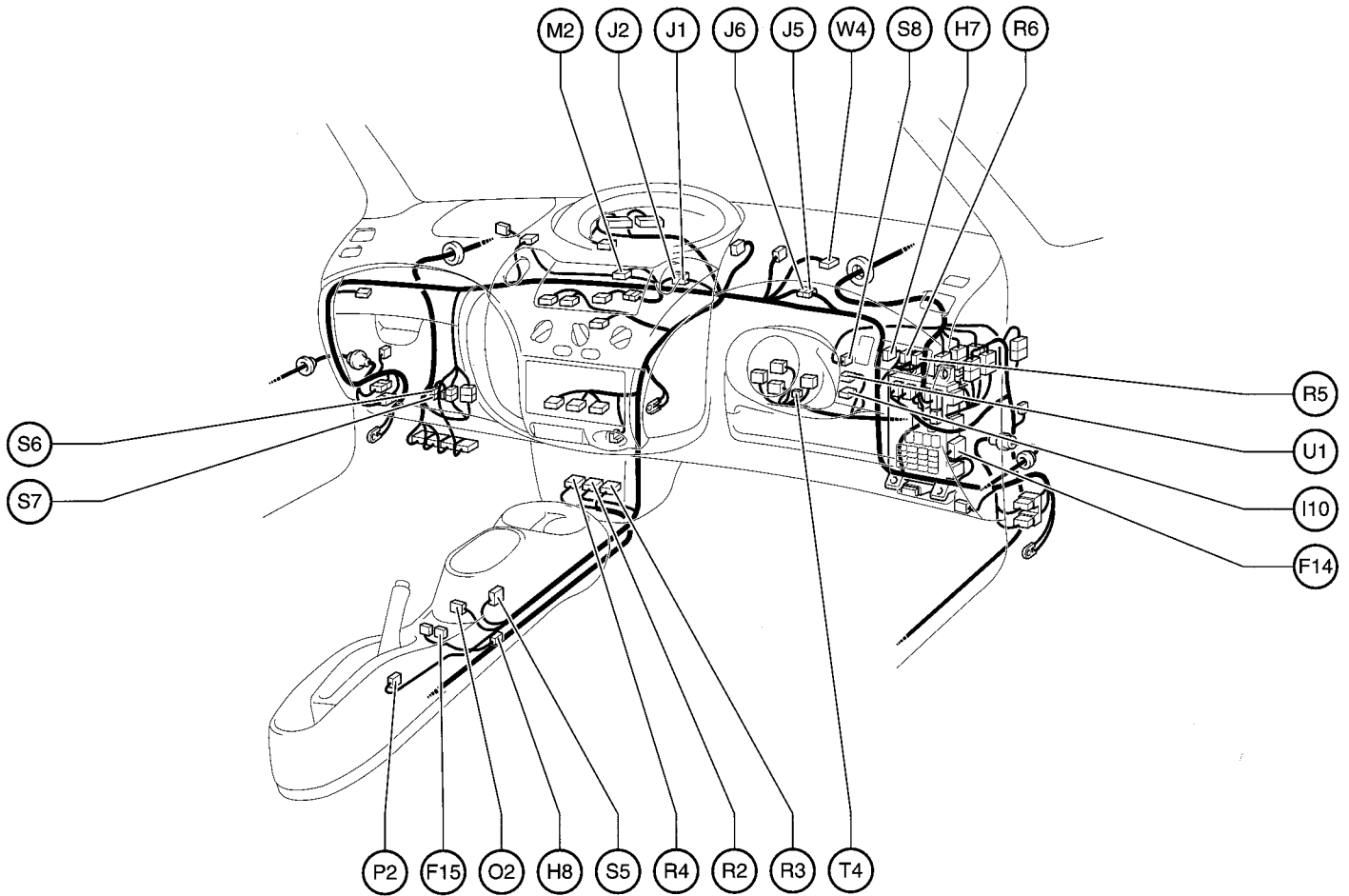

F 14 Front Fog Light Relay  
F 15 Front Fog Light SW

H 7 Headlight Beam Level Control SW  
H 8 Heated Oxygen Sensor (Bank 1 Sensor 2)

I 10 Ignition SW

J 1 Junction Connector  
J 2 Junction Connector  
J 5 Junction Connector  
J 6 Junction Connector

M 2 Multi Display

O 2 O/D Main SW

P 2 Parking Brake SW

R 2 Radio and Player  
R 3 Radio and Player  
R 4 Radio and Player  
R 5 Rear Fog Light SW  
R 6 Remote Control Mirror SW

S 5 Shift Lock Control SW  
S 6 Short Connector  
S 7 Short Connector  
S 8 Stop Light SW

T 4 Transponder Key Amplifier

U 1 Unlock Warning SW

W 4 Wireless Door Lock Control Receiver

## G ELECTRICAL WIRING ROUTING

### Position of Parts in Body

[RHD]

\*1 : w/ Double Locking System  
\*2 : w/o Double Locking System

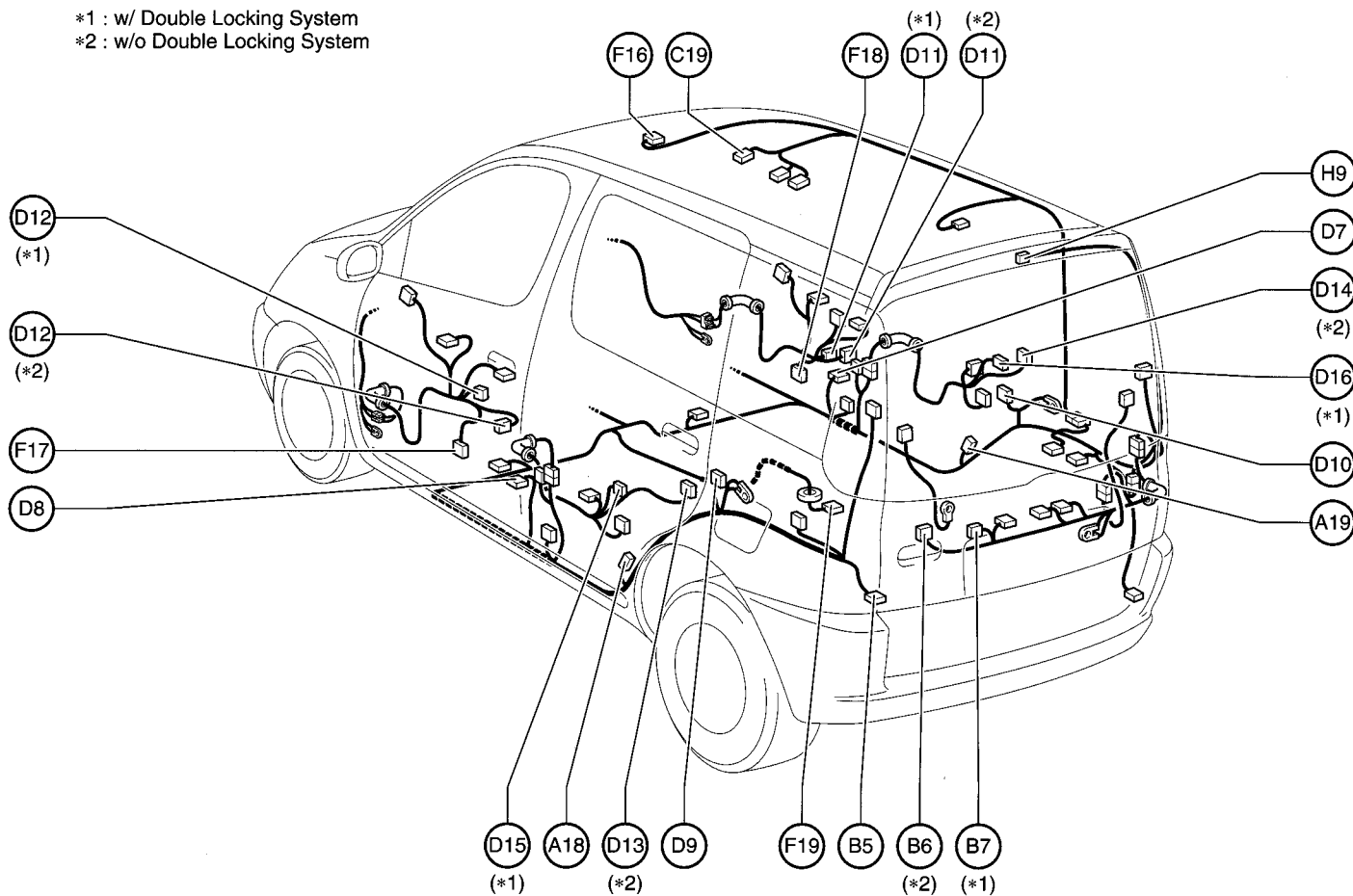

A18 ABS Speed Sensor Rear LH  
A19 ABS Speed Sensor Rear RH

B 5 Back Door Courtesy SW  
B 6 Back Door Lock Motor  
B 7 Back Door Lock Motor and SW

C19 Center Interior Light

D 7 Door Courtesy SW (Driver's Side)  
D 8 Door Courtesy SW (Front Passenger's Side)  
D 9 Door Courtesy SW Rear LH  
D10 Door Courtesy SW Rear RH  
D11 Door Lock Motor and SW (Driver's Side)  
D12 Door Lock Motor and SW (Front Passenger's Side)  
D13 Door Lock Motor Rear LH  
D14 Door Lock Motor Rear RH  
D15 Door Lock Motor and SW Rear LH  
D16 Door Lock Motor and SW Rear RH

F16 Front Interior Light  
F17 Front Speaker LH (Door)  
F18 Front Speaker RH (Door)  
F19 Fuel Pump and Fuel Sender  
H 9 High Mounted Stop Light

## Position of Parts in Body

**[RHD]**

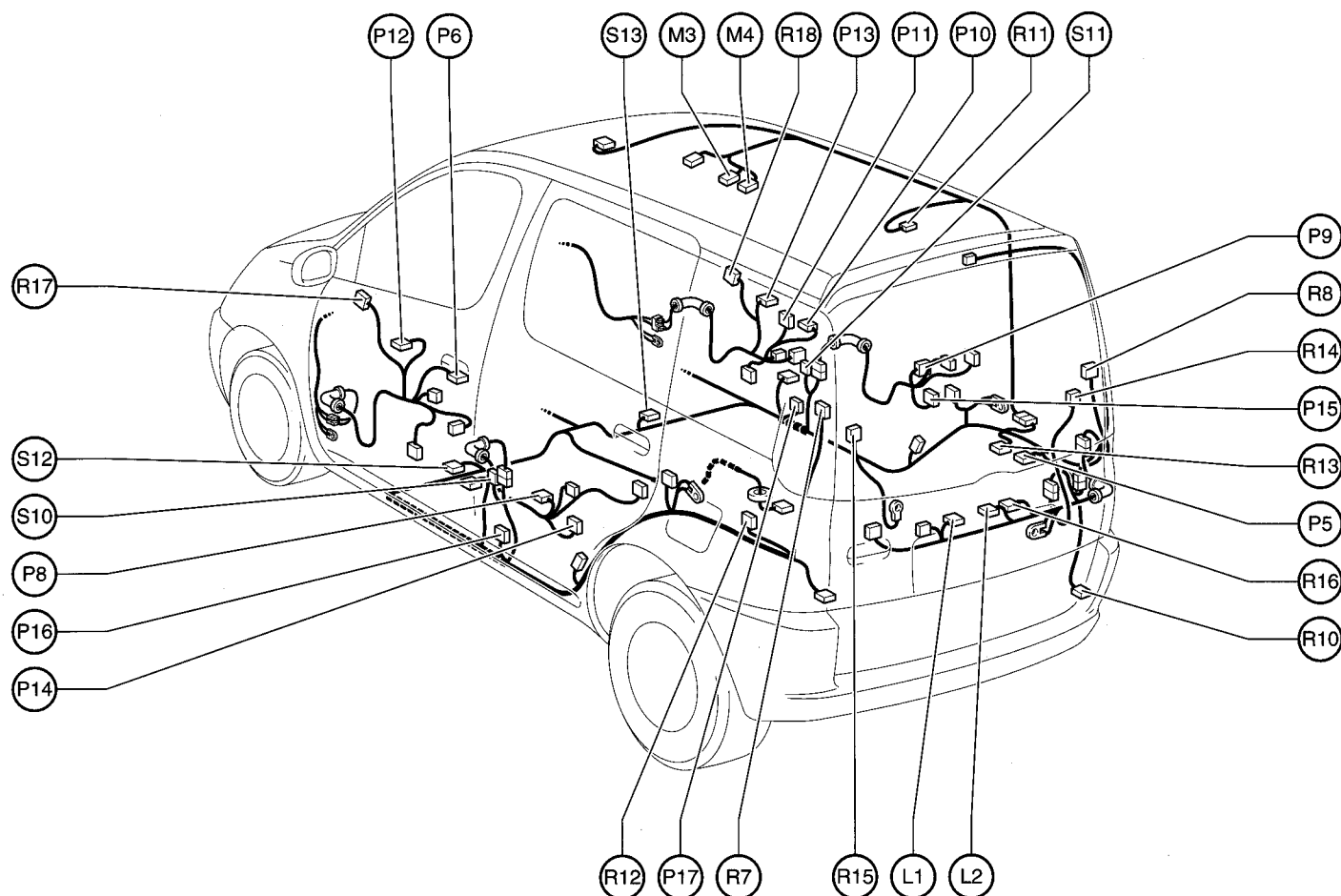

L 1 License Plate Light LH  
L 2 License Plate Light RH

M 3 Moon Roof Control SW and Moon Roof Control Relay  
M 4 Moon Roof Motor and Limit SW

P 5 Power Outlet  
P 6 Power Window Control SW Front LH  
P 8 Power Window Control SW Rear LH  
P 9 Power Window Control SW Rear RH  
P 10 Power Window Master SW  
P 11 Power Window Master SW  
P 12 Power Window Motor Front LH  
P 13 Power Window Motor Front RH  
P 14 Power Window Motor Rear LH  
P 15 Power Window Motor Rear RH  
P 16 Pretensioner LH  
P 17 Pretensioner RH

R 7 Rear Combination Light LH  
R 8 Rear Combination Light RH  
R 10 Rear Fog Light RH  
R 11 Rear Interior Light  
R 12 Rear Speaker LH  
R 13 Rear Speaker RH  
R 14 Rear Window Defogger  
R 15 Rear Window Defogger  
R 16 Rear Wiper Motor  
R 17 Remote Control Mirror LH  
R 18 Remote Control Mirror RH

S 10 Side Airbag Sensor LH  
S 11 Side Airbag Sensor RH  
S 12 Side Airbag Squib LH  
S 13 Side Airbag Squib RH

## G ELECTRICAL WIRING ROUTING

□ : Location of Connector Joining Wire Harness and Wire Harness

▽ : Location of Ground Points

[LHD]

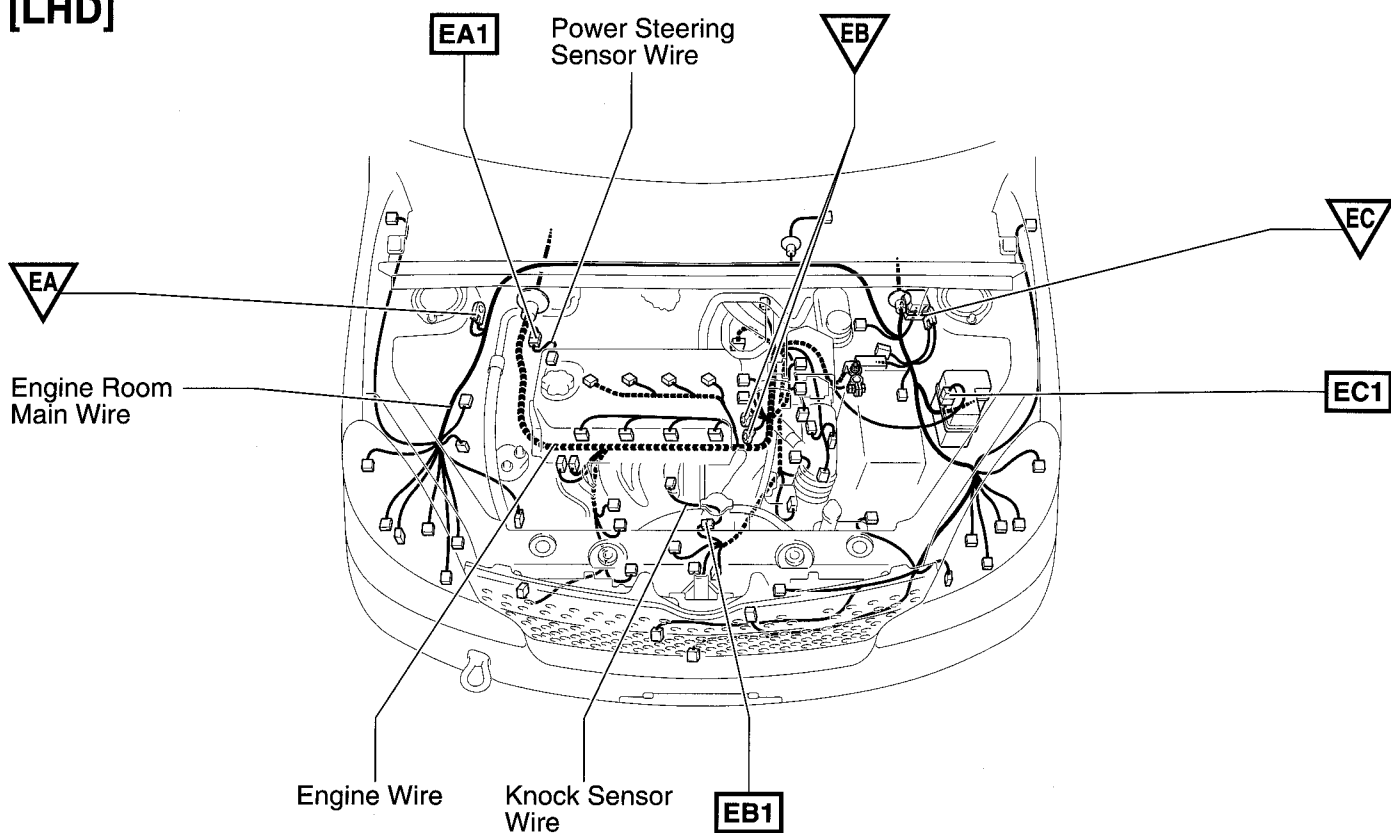

○ : Location of Splice Points

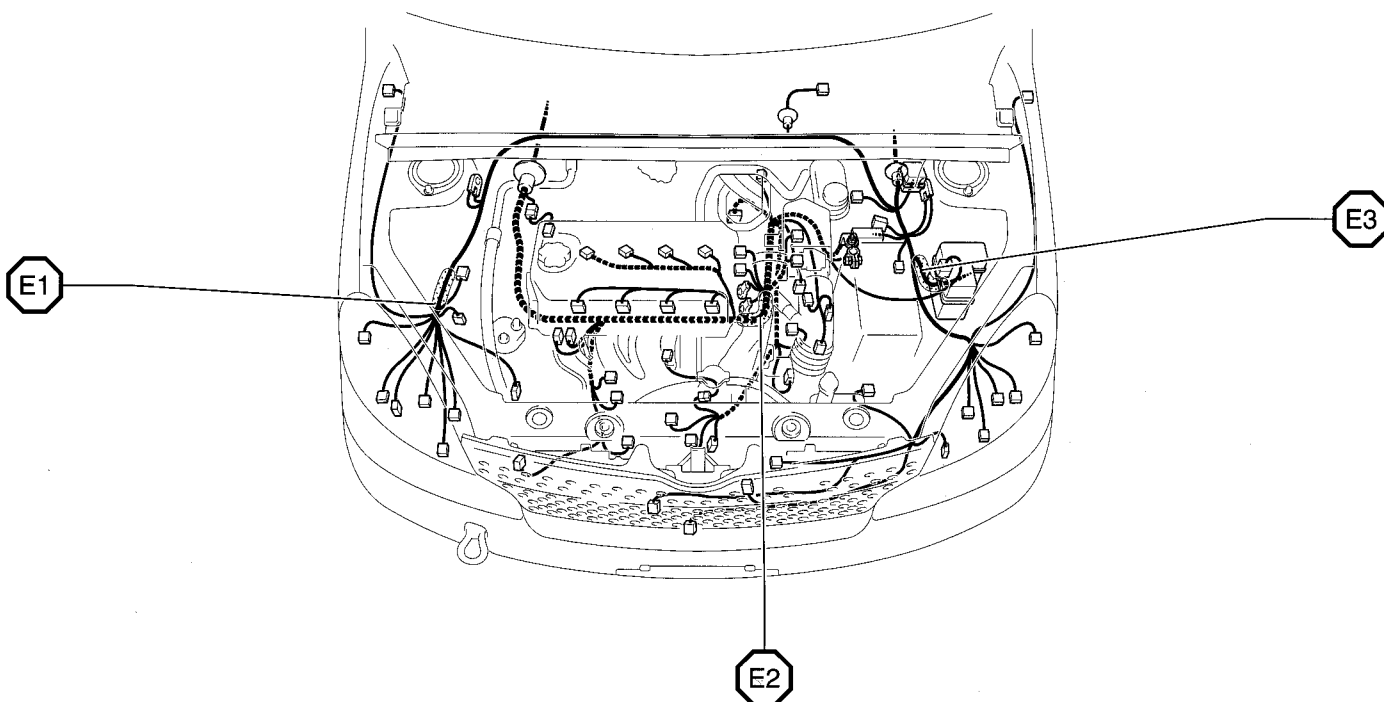

## Connector Joining Wire Harness and Wire Harness

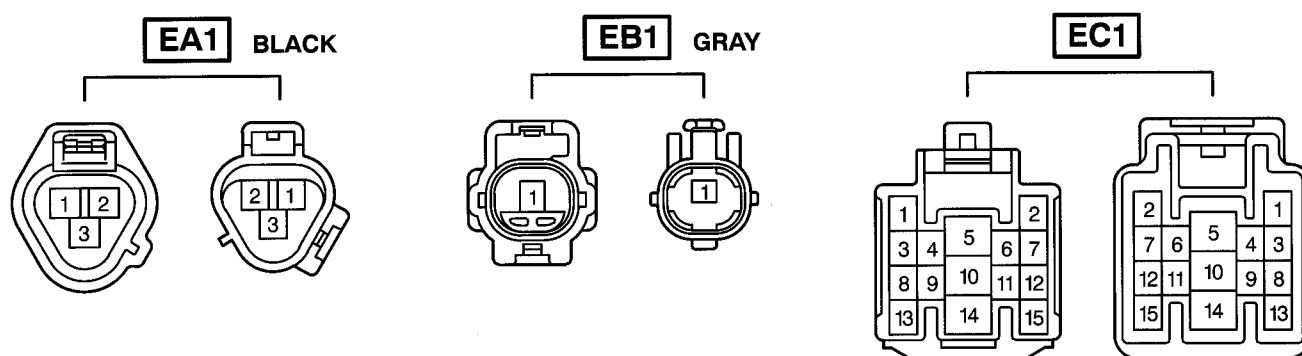

Code	Joining Wire Harness and Wire Harness (Connector Location)
EA1	Engine Wire and Power Steering Sensor Wire (Front Right Fender Apron)
EB1	Engine Wire and Knock Sensor Wire (Near the Starter)
EC1	Engine Wire and Engine Room Main Wire (Inside of Engine Room R/B No.1)

## G ELECTRICAL WIRING ROUTING

□ : Location of Connector Joining Wire Harness and Wire Harness

[LHD]

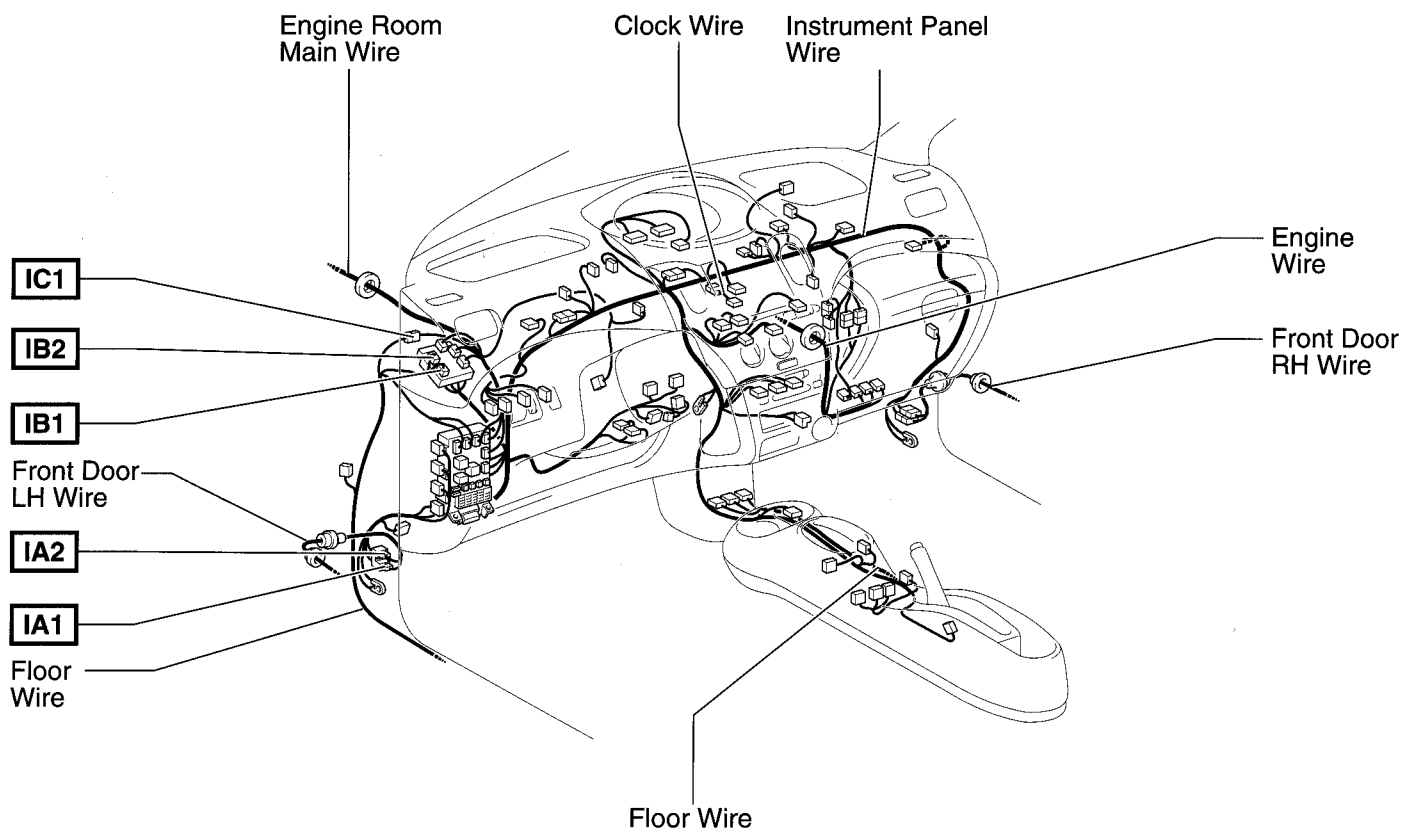

▽ : Location of Ground Points

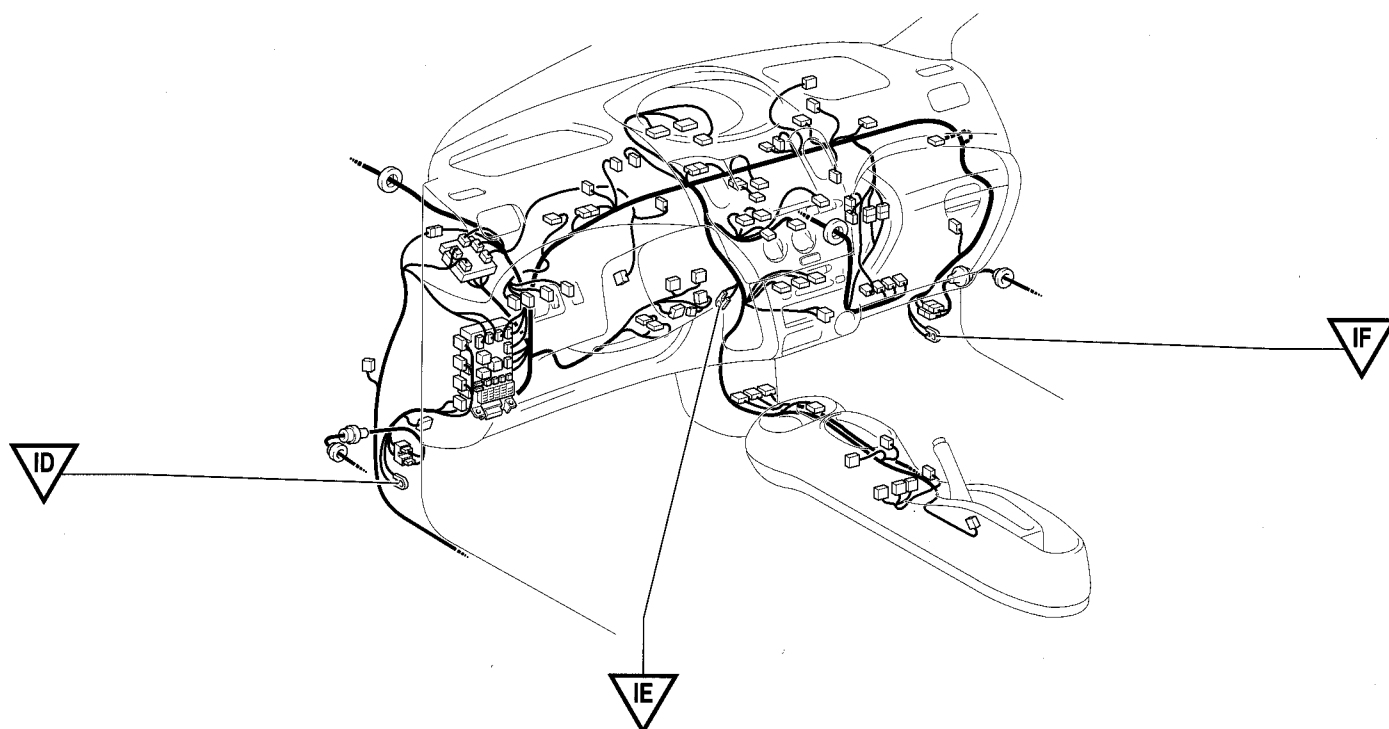

## Connector Joining Wire Harness and Wire Harness

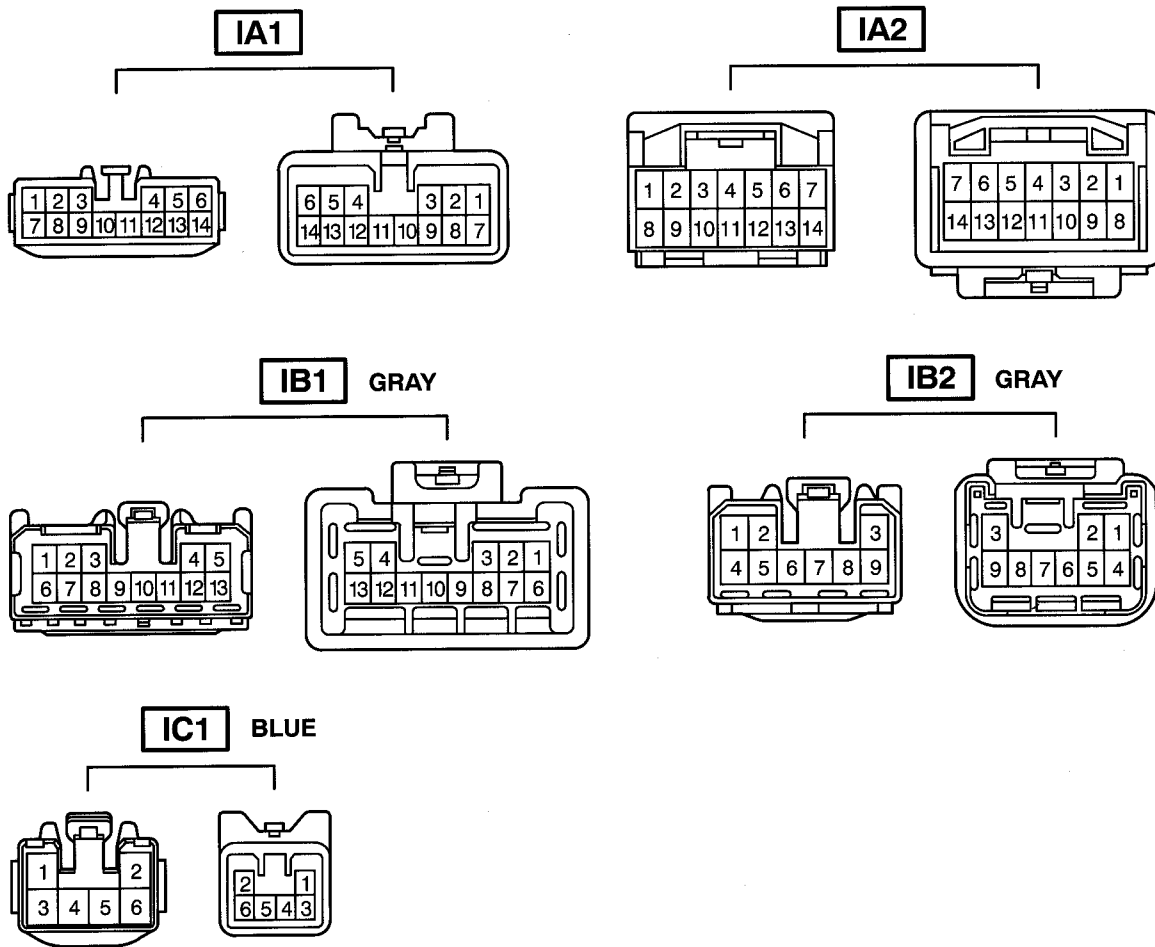

Code	Joining Wire Harness and Wire Harness (Connector Location)
IA1	Front Door LH Wire and Instrument Panel Wire (Left Kick Panel)
IA2	
IB1	Floor Wire and Instrument Panel Wire (Left Side of Instrument Panel)
IB2	
IC1	Engine Room Main Wire and Floor Wire (Left Side of Instrument Panel)



## G ELECTRICAL WIRING ROUTING

**□ : Location of Connector Joining Wire Harness and Wire Harness**

**[LHD]**

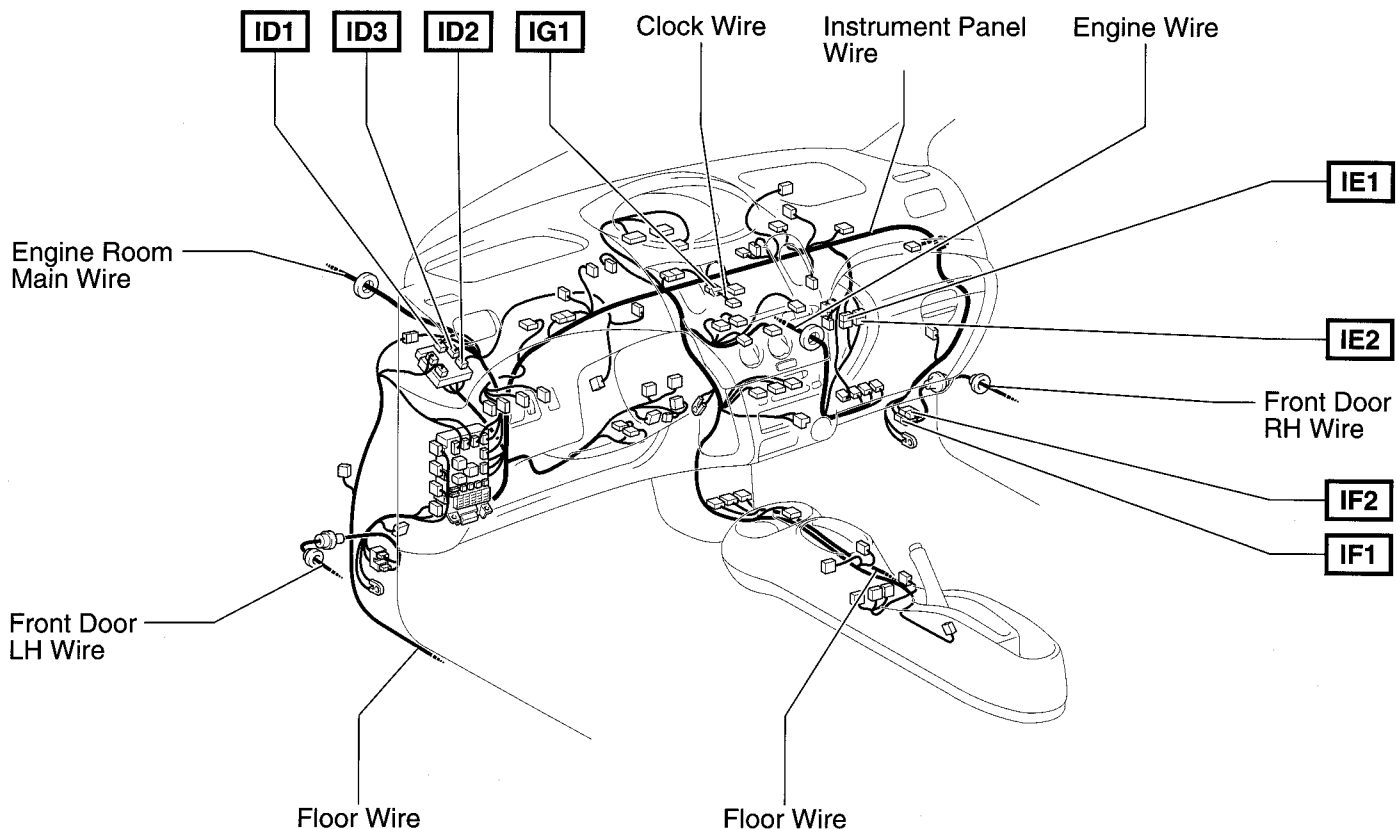

**○ : Location of Splice Points**

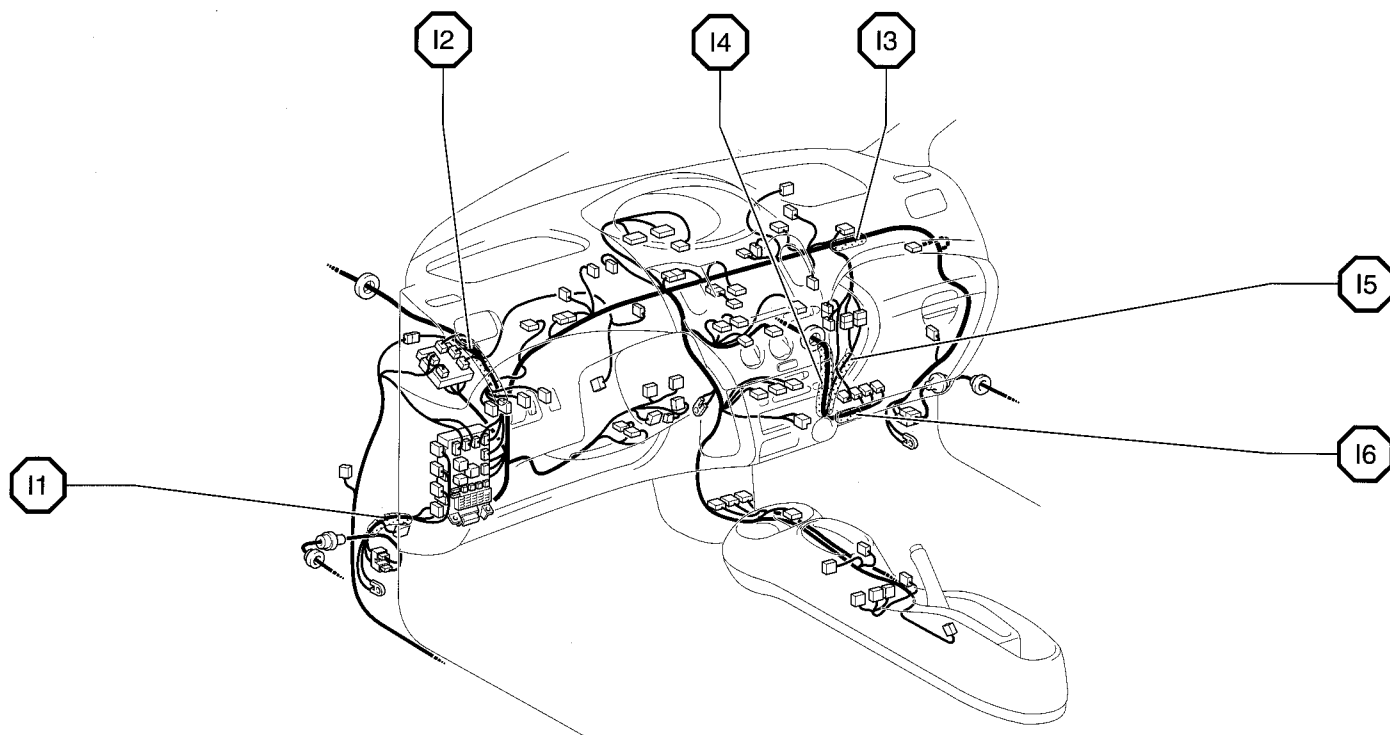

## Connector Joining Wire Harness and Wire Harness

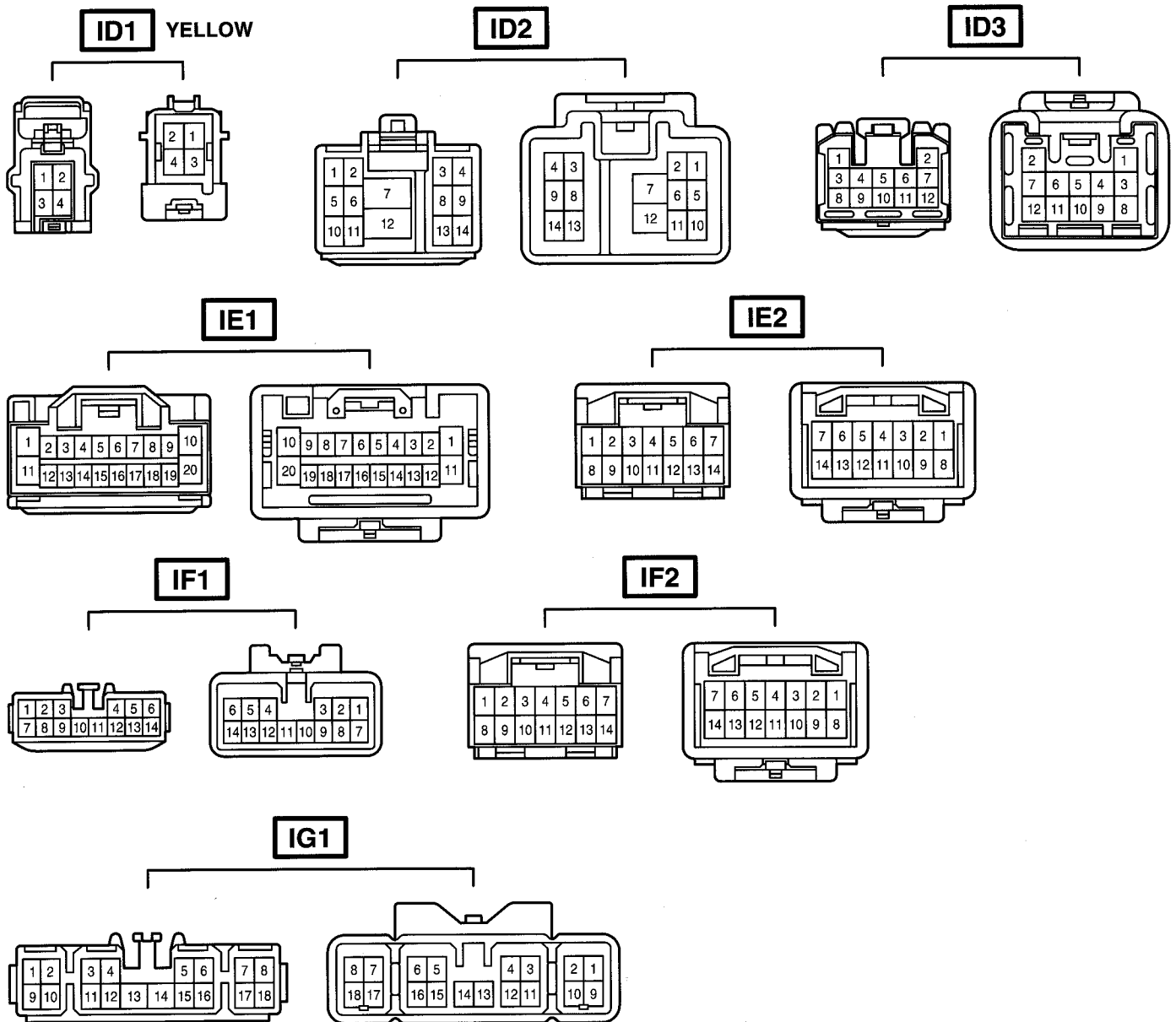

Code	Joining Wire Harness and Wire Harness (Connector Location)
ID1	
ID2	Engine Room Main Wire and Instrument Panel Wire (Left Side of Instrument Panel)
ID3	
IE1	Engine Wire and Instrument Panel Wire (Behind the Glove Box)
IE2	
IF1	Front Door RH Wire and Instrument Panel Wire (Right Kick Panel)
IF2	
IG1	Instrument Panel Wire and Clock Wire (Behind the Instrument Panel Center)

## G ELECTRICAL WIRING ROUTING

□ : Location of Connector Joining Wire Harness and Wire Harness

▽ : Location of Ground Points

[LHD]

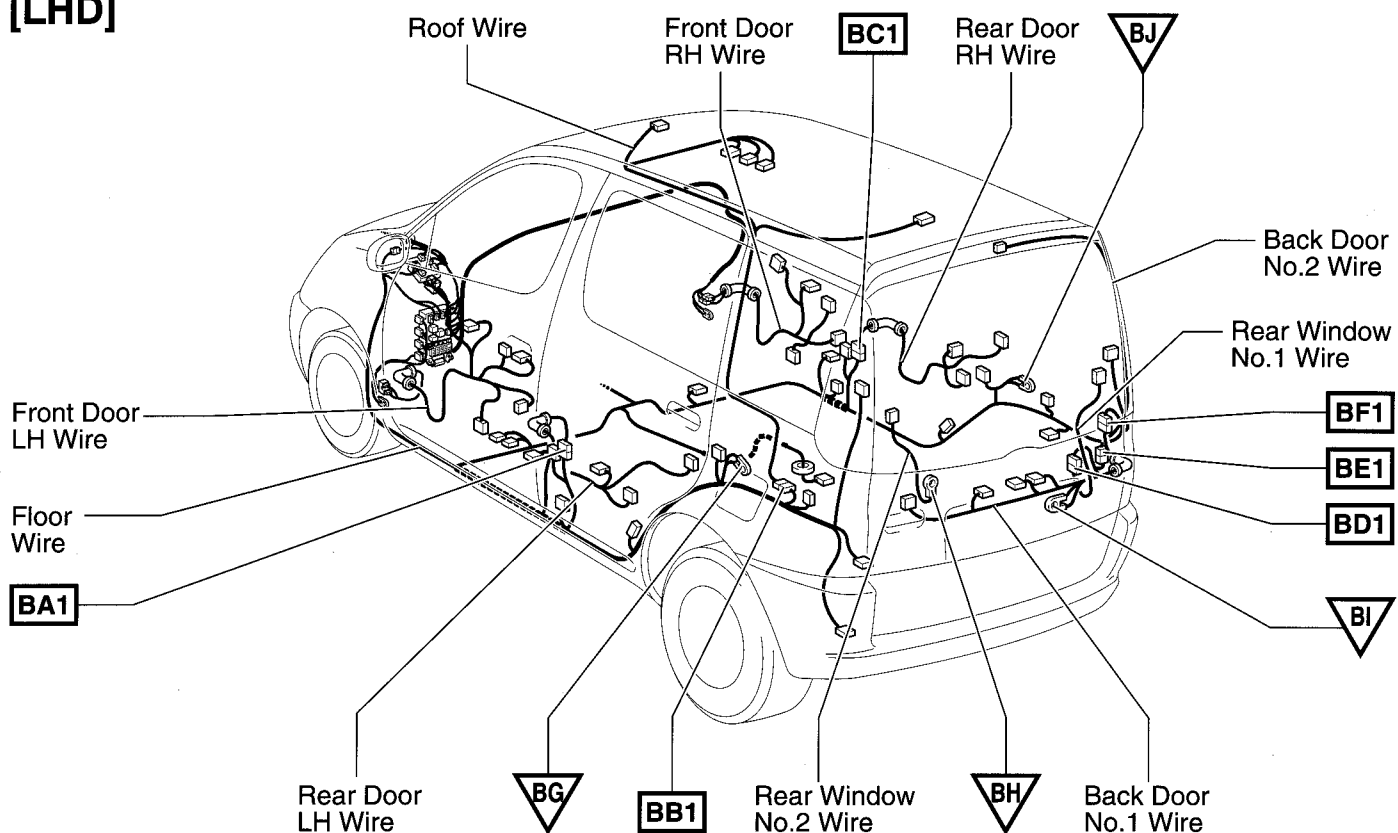

○ : Location of Splice Points

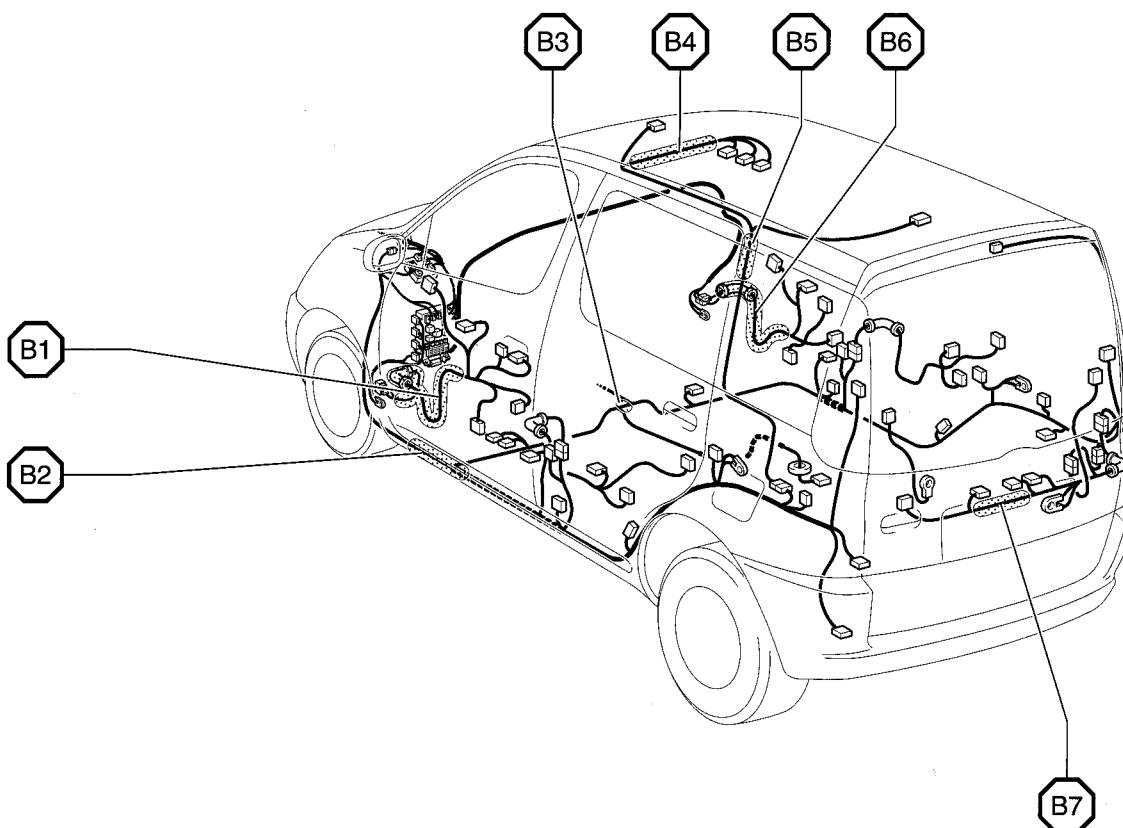

## Connector Joining Wire Harness and Wire Harness

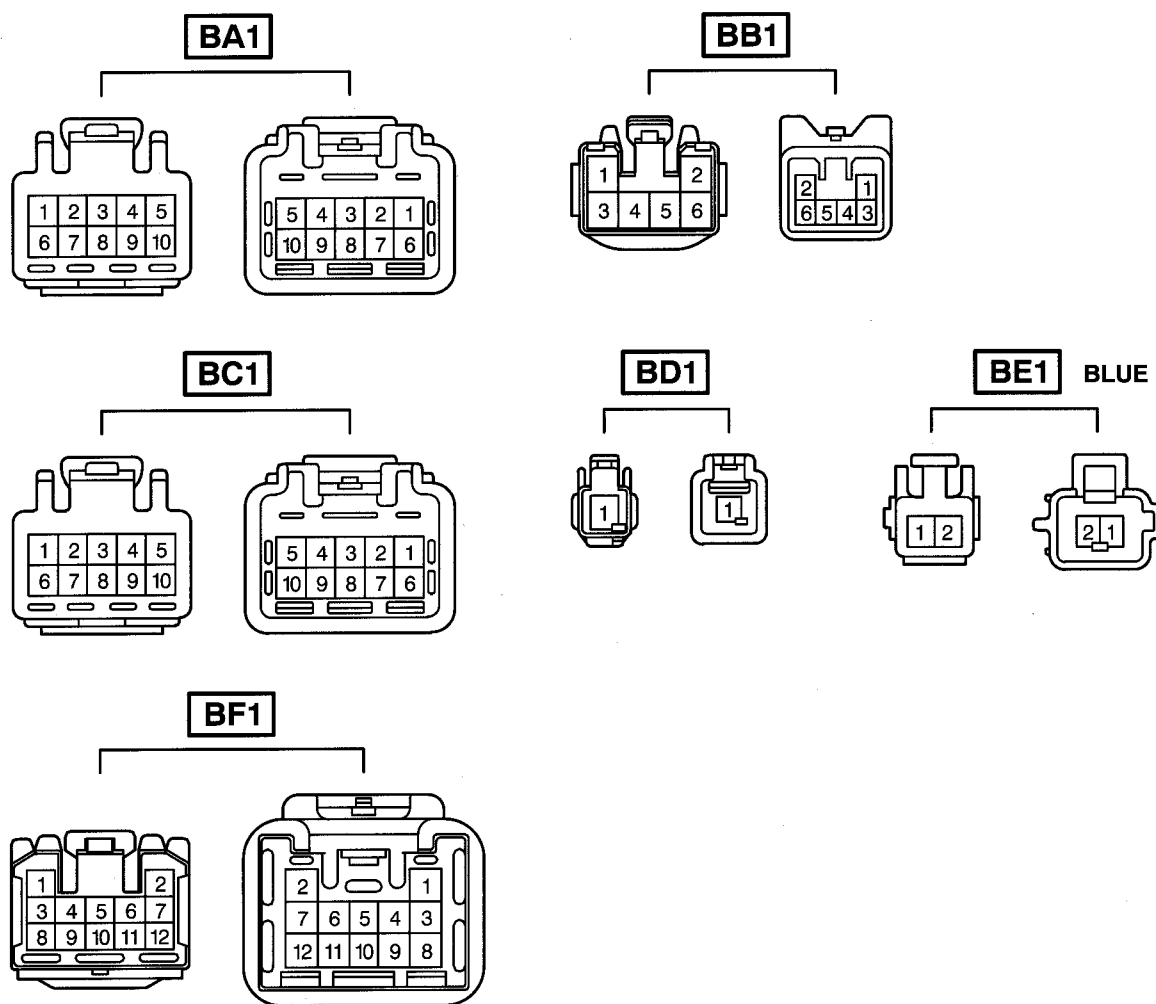

Code	Joining Wire Harness and Wire Harness (Connector Location)
BA1	Rear Door LH Wire and Floor Wire (Under the Left Center Pillar)
BB1	Roof Wire and Floor Wire (Left Rear Side Quarter Panel)
BC1	Rear Door RH Wire and Floor Wire (Under the Right Center Pillar)
BD1	Rear Window No.1 Wire and Back Door No.1 Wire (Right Side of Back Door)
BE1	Back Door No.2 Wire and Back Door No.1 Wire (Right Side of Back Door)
BF1	Back Door No.1 Wire and Floor Wire (Right Side of Back Door)

## G ELECTRICAL WIRING ROUTING

□ : Location of Connector Joining Wire Harness and Wire Harness

▽ : Location of Ground Points

[RHD]

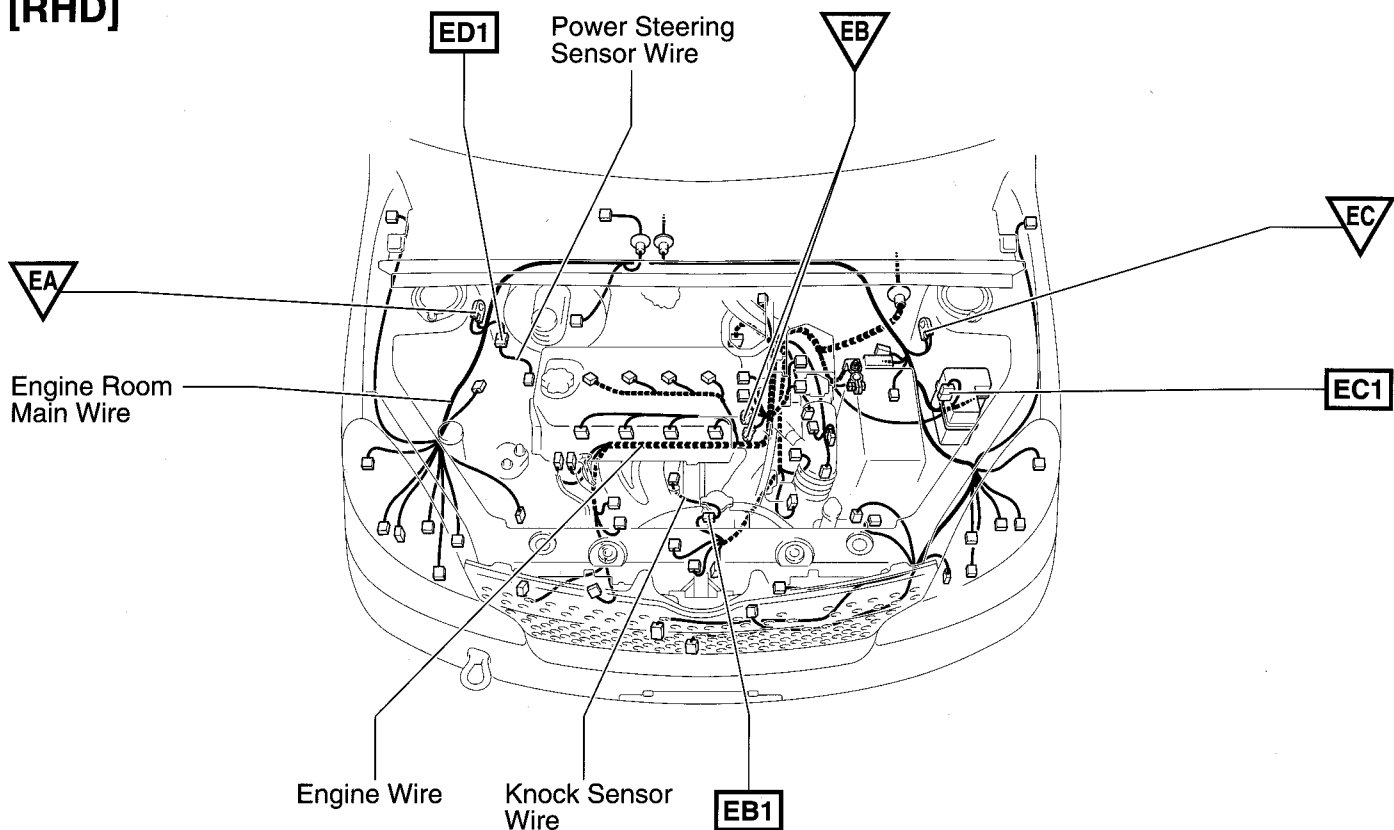

○ : Location of Splice Points

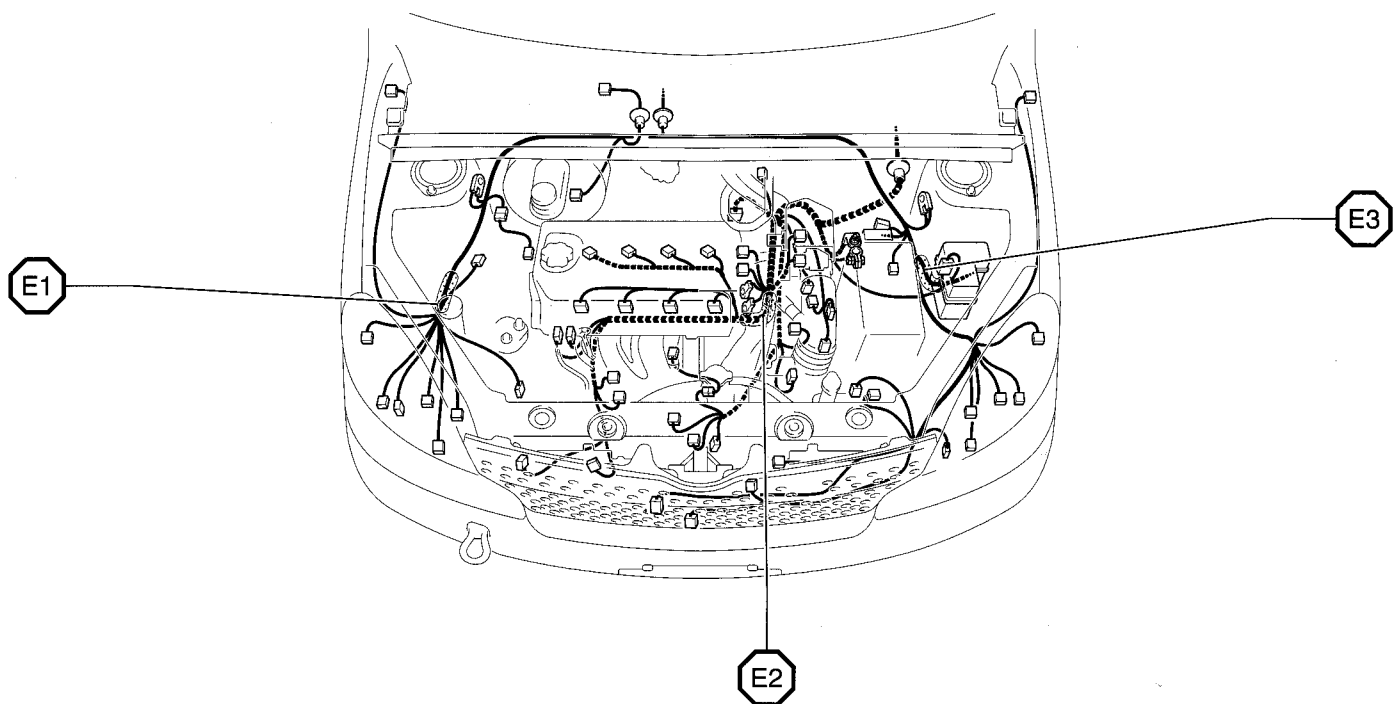

## Connector Joining Wire Harness and Wire Harness

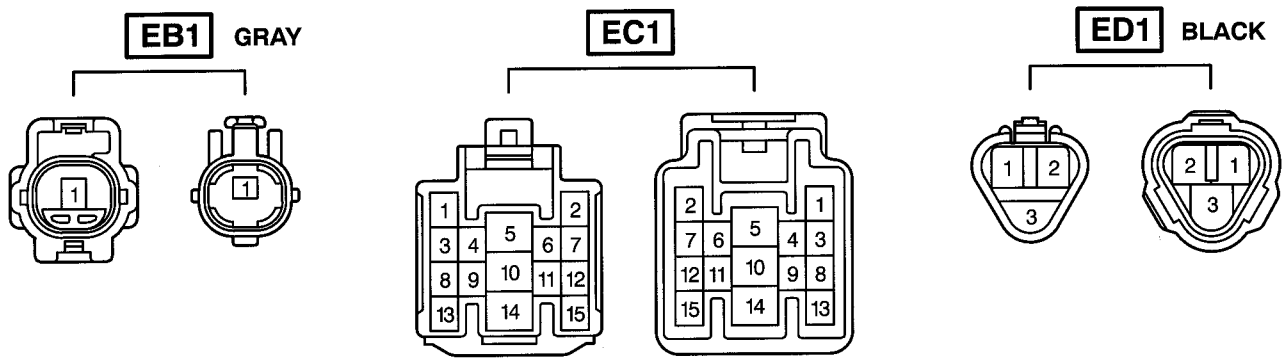

Code	Joining Wire Harness and Wire Harness (Connector Location)
EB1	Engine Wire and Knock Sensor Wire (Near the Starter)
EC1	Engine Wire and Engine Room Main Wire (Inside of Engine Room R/B No.1)
ED1	Engine Room Main Wire and Power Steering Sensor Wire (Front Right Fender Apron)

## G ELECTRICAL WIRING ROUTING

□ : Location of Connector Joining Wire Harness and Wire Harness

[RHD]

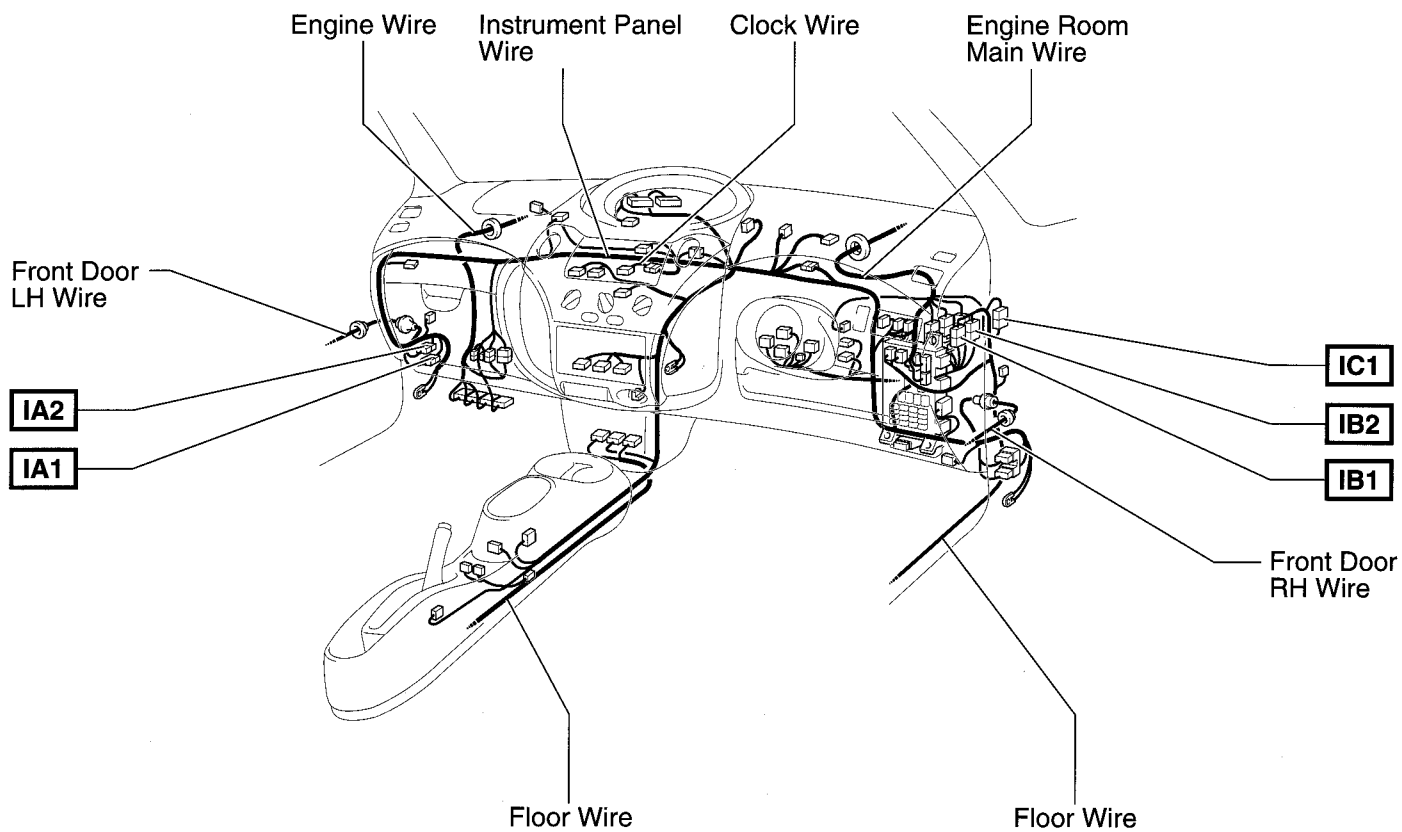

▽ : Location of Ground Points

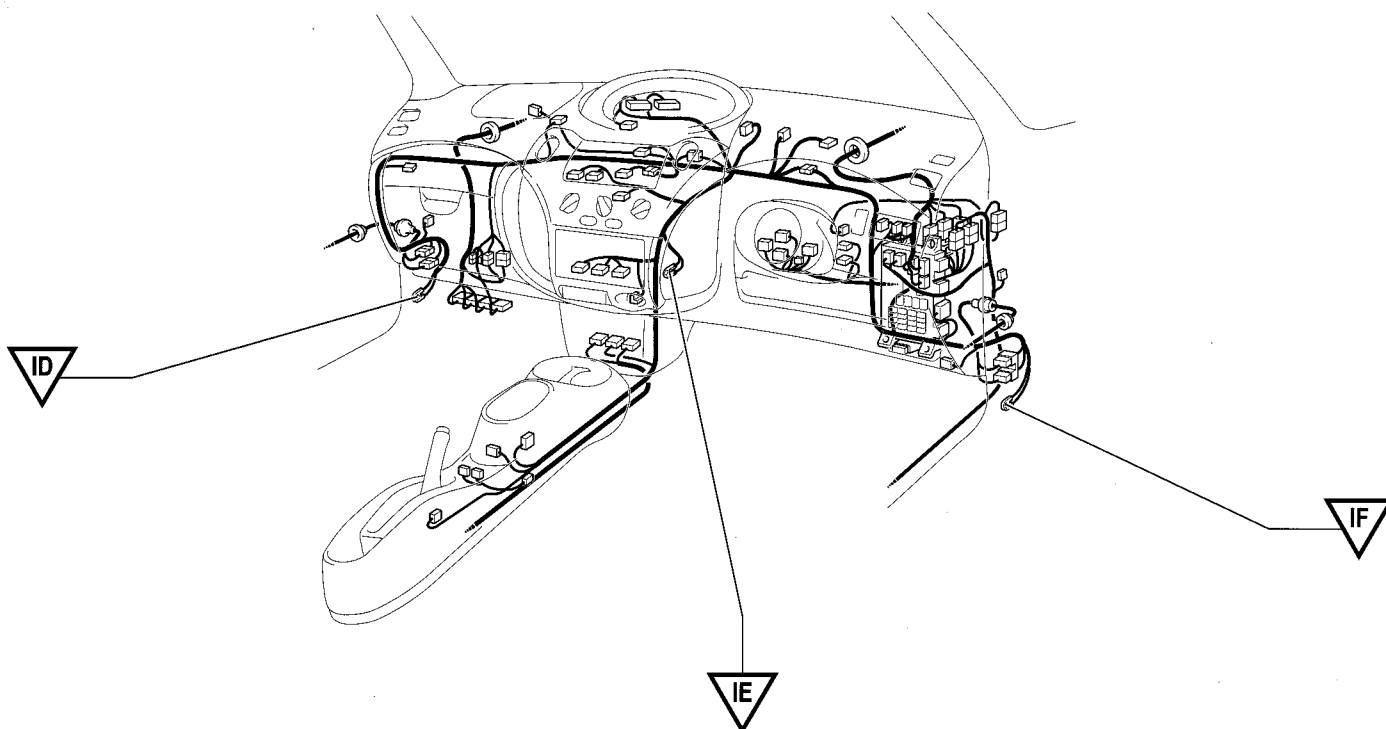

## Connector Joining Wire Harness and Wire Harness

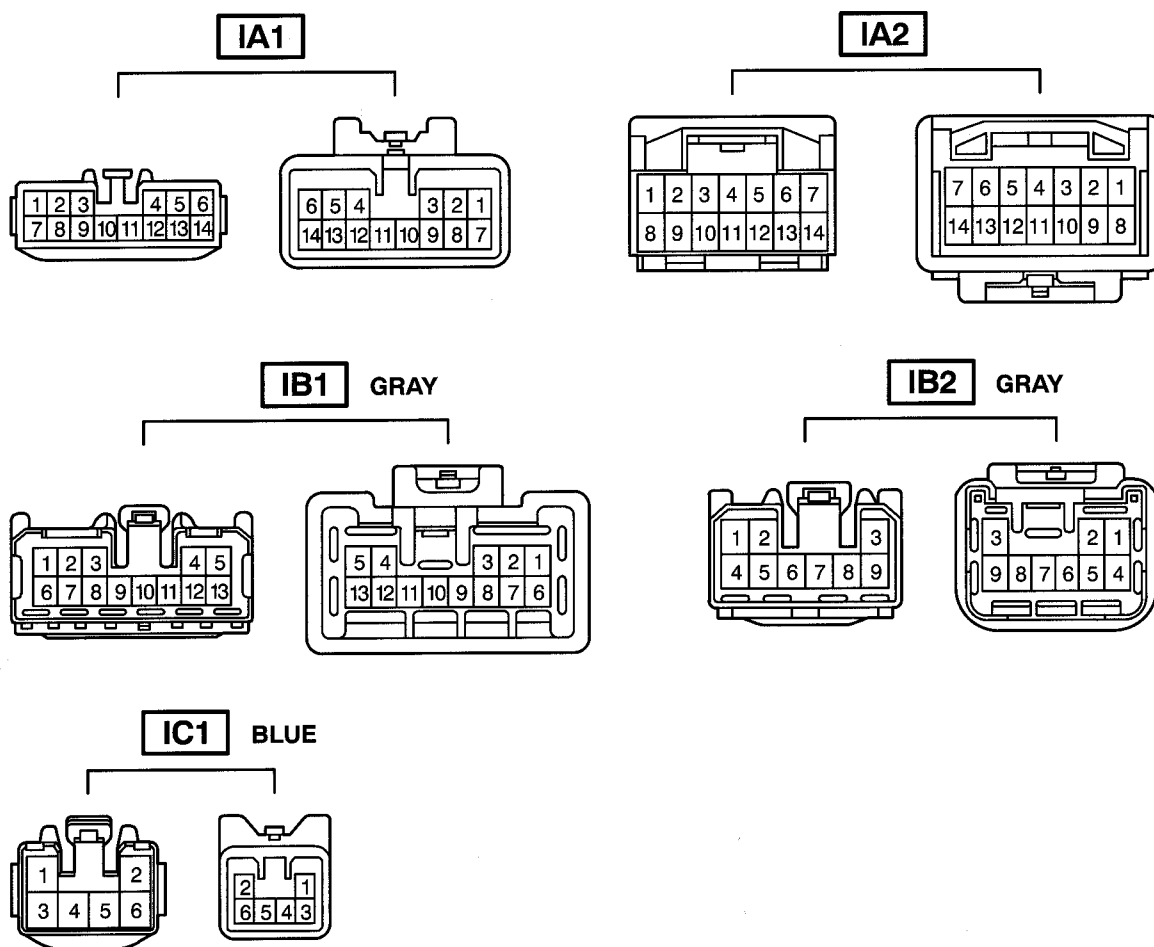

Code	Joining Wire Harness and Wire Harness (Connector Location)
IA1	Front Door LH Wire and Instrument Panel Wire (Left Kick Panel)
IA2	
IB1	Floor Wire and Instrument Panel Wire (Right Side of Instrument Panel)
IB2	
IC1	Engine Room Main Wire and Floor Wire (Right Side of Instrument Panel)



## G ELECTRICAL WIRING ROUTING

□ : Location of Connector Joining Wire Harness and Wire Harness

[RHD]

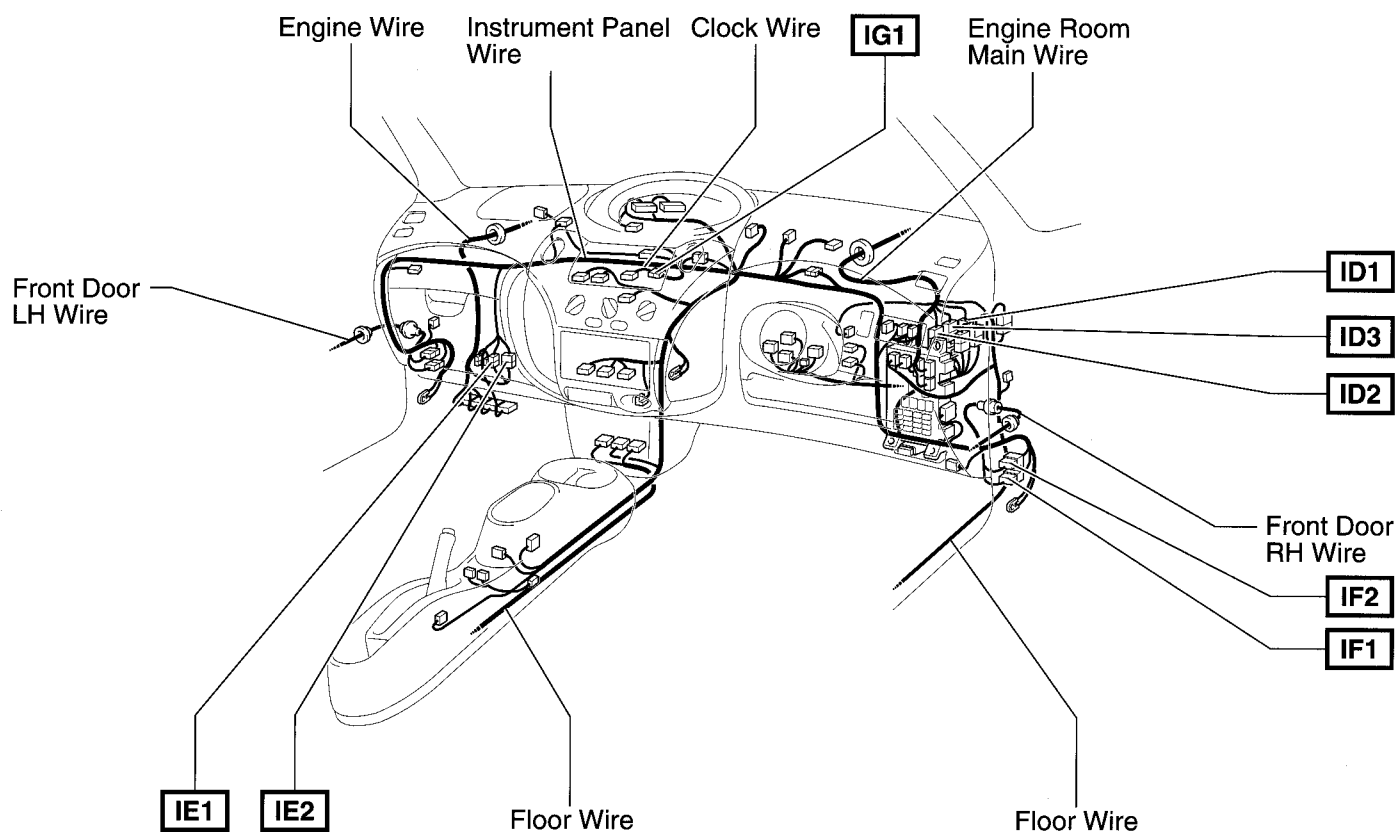

○ : Location of Splice Points

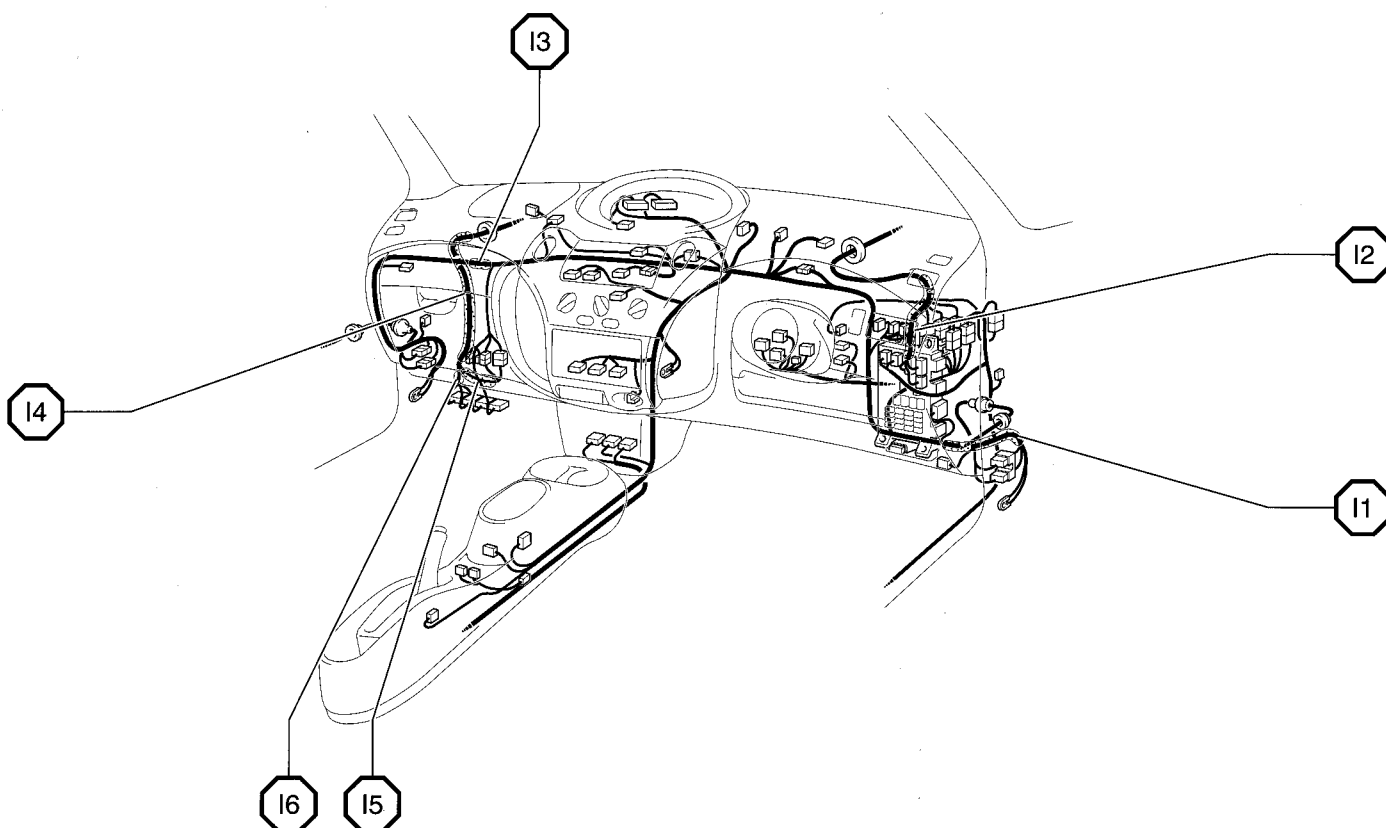

## Connector Joining Wire Harness and Wire Harness

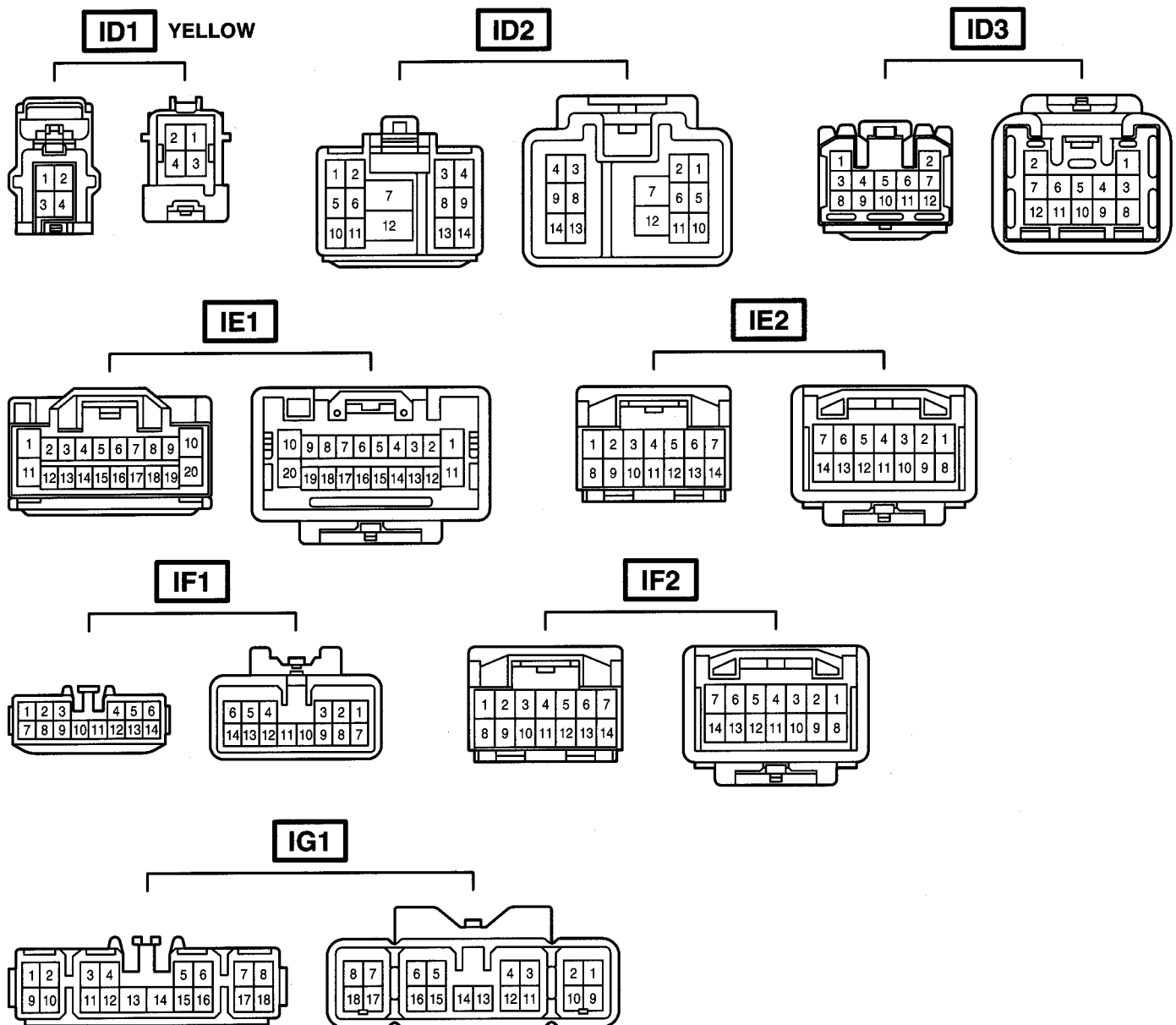

Code	Joining Wire Harness and Wire Harness (Connector Location)
ID1	Engine Room Main Wire and Instrument Panel Wire (Right Side of Instrument Panel)
ID2	
ID3	
IE1	Engine Wire and Instrument Panel Wire (Behind the Glove Box)
IE2	
IF1	Front Door RH Wire and Instrument Panel Wire (Right Kick Panel)
IF2	
IG1	Instrument Panel Wire and Clock Wire (Behind the Instrument Panel Center)

## G ELECTRICAL WIRING ROUTING

□ : Location of Connector Joining Wire Harness and Wire Harness

▽ : Location of Ground Points

[RHD]

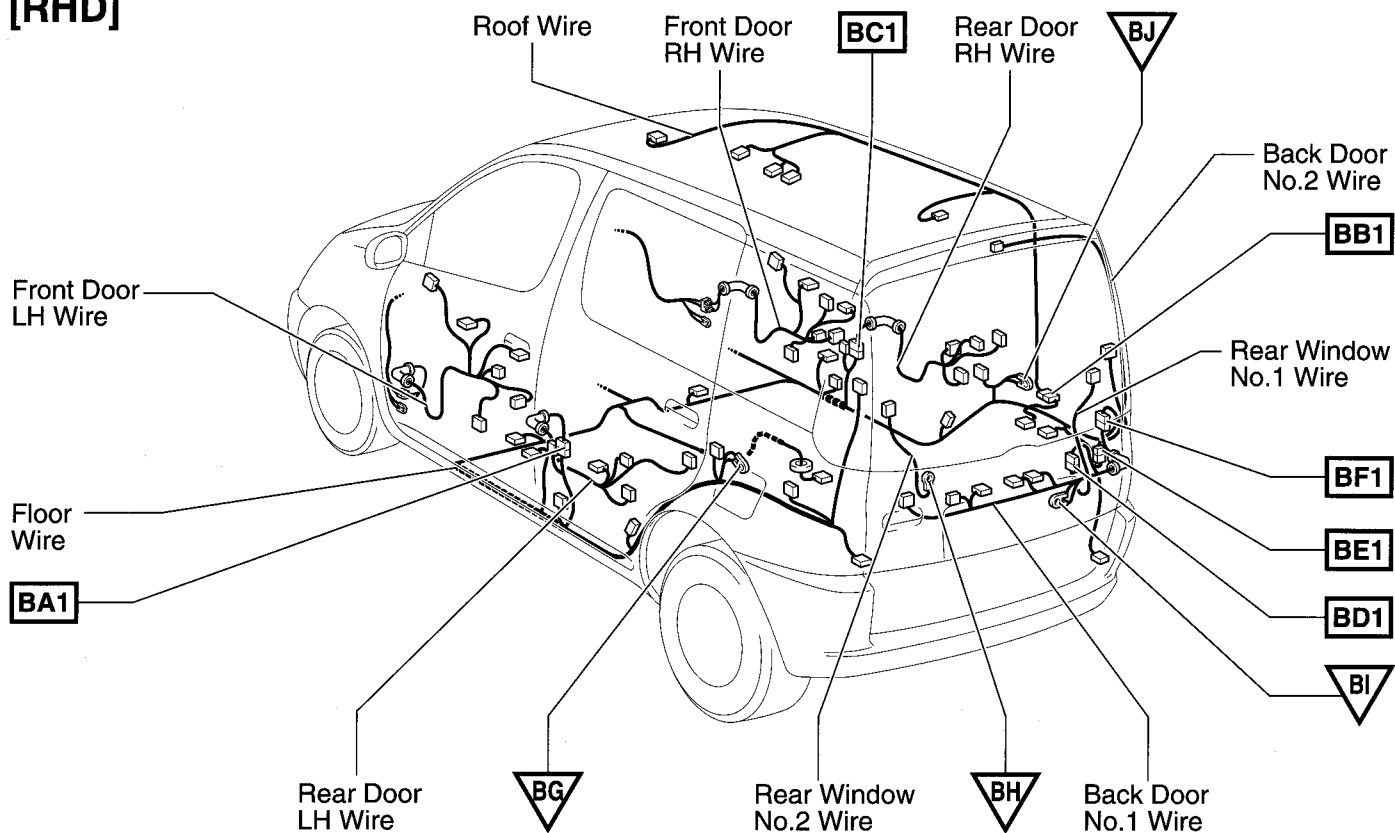

○ : Location of Splice Points

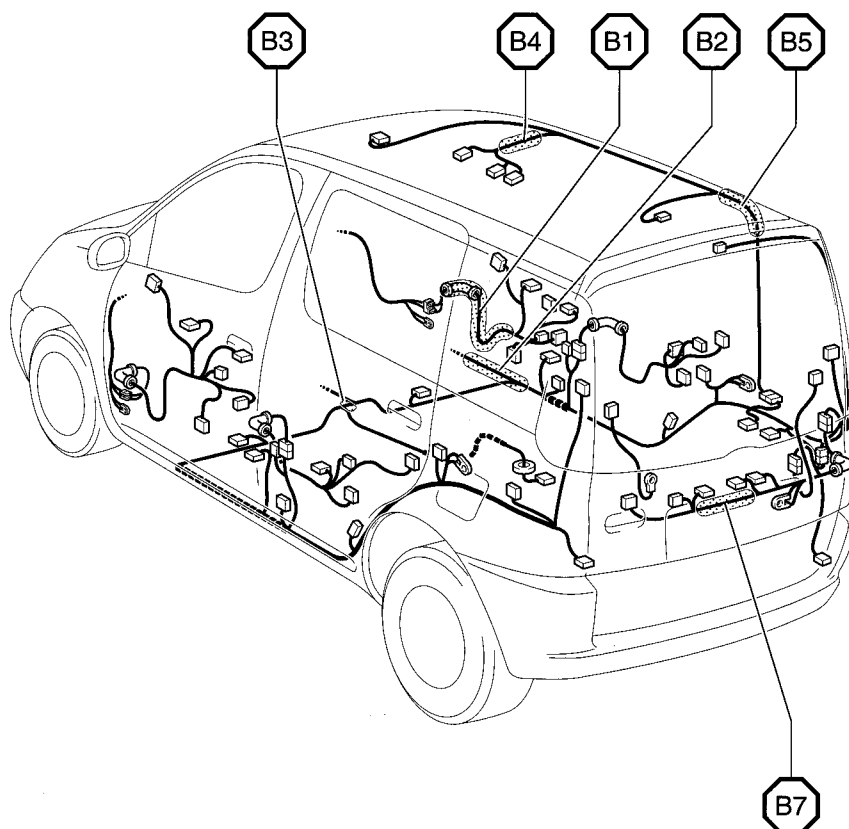

## Connector Joining Wire Harness and Wire Harness

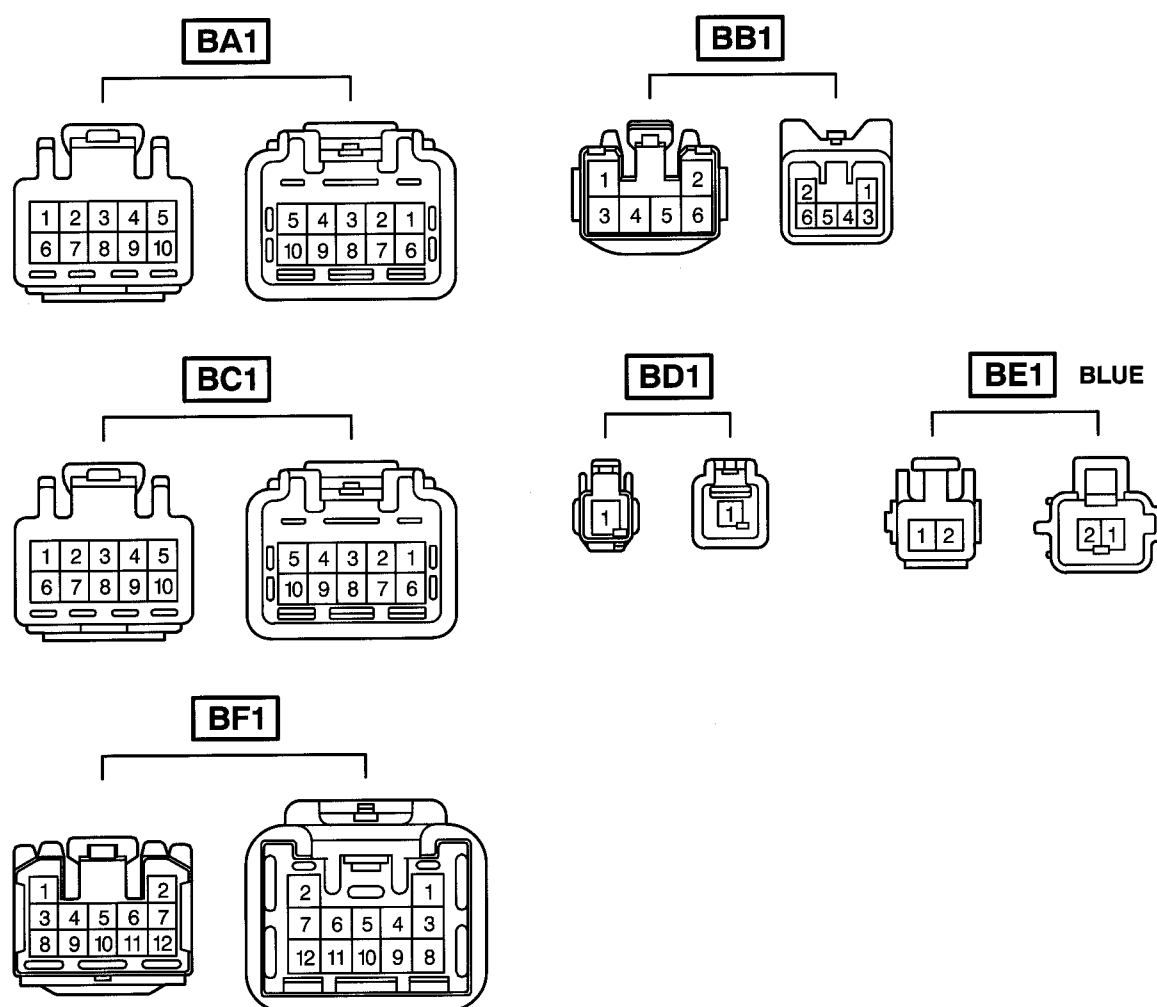

Code	Joining Wire Harness and Wire Harness (Connector Location)
BA1	Rear Door LH Wire and Floor Wire (Under the Left Center Pillar)
BB1	Roof Wire and Floor Wire (Right Rear Side Quarter Panel)
BC1	Rear Door RH Wire and Floor Wire (Under the Right Center Pillar)
BD1	Rear Window No.1 Wire and Back Door No.1 Wire (Right Side of Back Door)
BE1	Back Door No.2 Wire and Back Door No.1 Wire (Right Side of Back Door)
BF1	Back Door No.1 Wire and Floor Wire (Right Side of Back Door)